



SPARE PARTS / OPTIONAL EXTRAS MANUAL FOR THE CADDY MODULAR SEATING SYSTEM

VERSION 1 / OCTOBER 2017 ONWARDS



SPARE PARTS / OPTIONAL EXTRAS INDEX MANUAL FOR THE CADDY MODULAR SEATING SYSTEM

VERSION 1 / OCTOBER 2017 ONWARD

DIA No.	DIAGRAM TITLE
CADDY-DIA-1	STANDARD SLOT BACKREST & SEAT BOARD INTERFACING ASSEMBLY
CADDY-DIA-2	POSITIVE LOCKING BACKREST & SEAT BOARD INTERFACING ASSEMBLY
CADDY-DIA-3	SEAT BOARD WHEELCHAIR INTERFACING FIXING OPTIONS ASSEMBLY
CDY-03-03-01-INDEX	SEAT BOARD ADJUSTER BRACKET INDEX
CADDY-DIA-4	BACKREST CUSHION OPTIONS ASSEMBLY
CADDY-DIA-5	SEAT CUSHION OPTIONS ASSEMBLY
CADDY-DIA-6	LATERAL THORACIC SWING FIXED / SWING AWAY OPTION ASSEMBLY
CADDY-DIA-7	LATERAL THORACIC SWING AWAY LINK / WRAP AROUND OPTION ASSEMBLY
CADDY-DIA-8	SHOULDER / TRICEP OPTIONS ASSEMBLY
CADDY-DIA-9	PELVIC PAD OPTIONS ASSEMBLY
CADDY-300-INDEX	CADDY LATERAL PELVIC WIDTH INDEX
CADDY-DIA-10	KNEE ADDUCTOR OPTIONS ASSEMBLY
CADDY-DIA-11	HEADREST MOUNTING OPTIONS ASSEMBLY
CADDY-DIA-12	FLIP DOWN POMMEL OPTIONS ASSEMBLY
CADDY-DIA-13	SEAT INTERFACE OPTIONS
CADDY-DIA-14	BACKREST INTERFACE OPTIONS

CADDY-SP-DIA-1
SPARE PARTS / OPTIONAL EXTRAS
STANDARD SLOT
BACKREST & SEAT BOARD INTERFACING
ASSEMBLY

DIAGRAM: 1		VERSION 1
(INTERNAL / EXTERNAL USE)		
DRAWN BY	WMJ	10/10/2017
CHECKED	AM	10/10/2017
APPROVED	WAC	10/10/2017

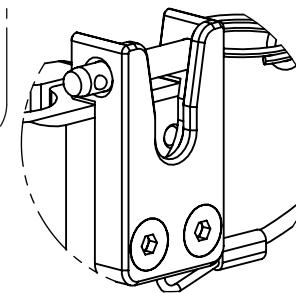

ITEM 4 SHOULD HAVE
FITTED **(SHORT SLOT)**
FRAME LOCATOR

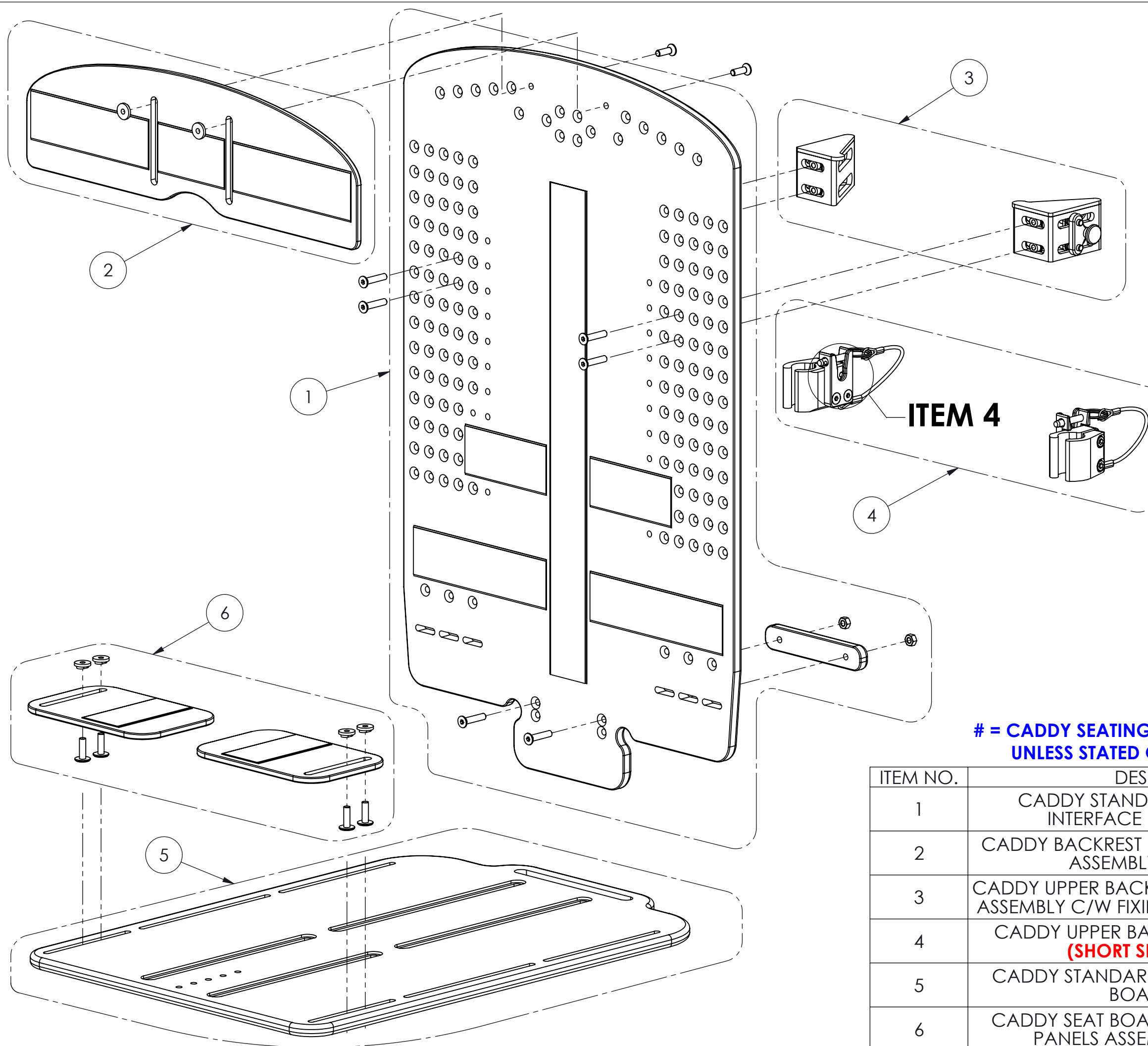

**# = CADDY SEATING MEASUREMENTS AS PER ORIGINAL ORDER
UNLESS STATED OTHERWISE ON REORDERING**

ITEM NO.	DESCRIPTION	PART NUMBER
1	CADDY STANDARD SLOT BACKREST INTERFACE PANEL ASSEMBLY	CDSP-04-01-#
2	CADDY BACKREST HEIGHT ADJUSTER PANEL ASSEMBLY C/W FIXINGS	CDSP-04-03-#
3	CADDY UPPER BACKREST FIXING BRACKET SET ASSEMBLY C/W FIXINGS & TWIN KEY WASHER	CDSP-04-04
4	CADDY UPPER BACKREST FRAME CLAMP (SHORT SLOT) ASSEMBLY	CDSP-04-05-STD
5	CADDY STANDARD SLOT INTERFACE SEAT BOARD PANEL	CDSP-03-01-#
6	CADDY SEAT BOARD DEPTH ADJUSTMENT PANELS ASSEMBLY C/W FIXINGS	CDSP-03-03-#

CADDY-SP-DIA-2
SPARE PARTS / OPTIONAL EXTRAS
POSITIVE LOCKING
BACKREST & SEAT BOARD INTERFACING
ASSEMBLY

DIAGRAM: 2		VERSION 1
(INTERNAL / EXTERNAL USE)		
DRAWN BY	WMJ	10/10/2017
CHECKED	AM	10/10/2017
APPROVED	WAC	10/10/2017

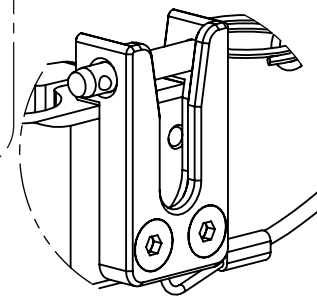

ITEM 4 SHOULD HAVE
FITTED **(LONG SLOT)**
FRAME LOCATOR

**# = CADDY SEATING MEASUREMENTS AS PER ORIGINAL ORDER
UNLESS STATED OTHERWISE ON REORDERING**

ITEM NO.	DESCRIPTION	PART NUMBER
1	CADDY POSITIVE LOCKING BACKREST INTERFACE PANEL ASSEMBLY	CDSP-04-02-#
2	CADDY BACKREST HEIGHT ADJUSTER PANEL ASSEMBLY C/W FIXINGS	CDSP-04-03-#
3	CADDY UPPER BACKREST FIXING BRACKET SET ASSEMBLY C/W FIXINGS & TWIN KEY WASHER	CDSP-04-04
4	CADDY UPPER BACKREST FRAME CLAMP (LONG SLOT) ASSEMBLY	CDSP-04-05- POV
5	CADDY POSITIVE LOCKING LOWER STEM MOUNT ASSEMBLY	CDSP-04-06
6	CADDY POSITIVE LOCKING SEAT BOARD LOCKING MOUNT ASSEMBLY	CDSP-04-07
7	CADDY POSITIVE LOCKING INTERFACE SEAT BOARD PANEL	CDSP-03-02-#
8	CADDY SEAT BOARD DEPTH ADJUSTMENT PANELS ASSEMBLY C/W FIXINGS	CDSP-03-03-#

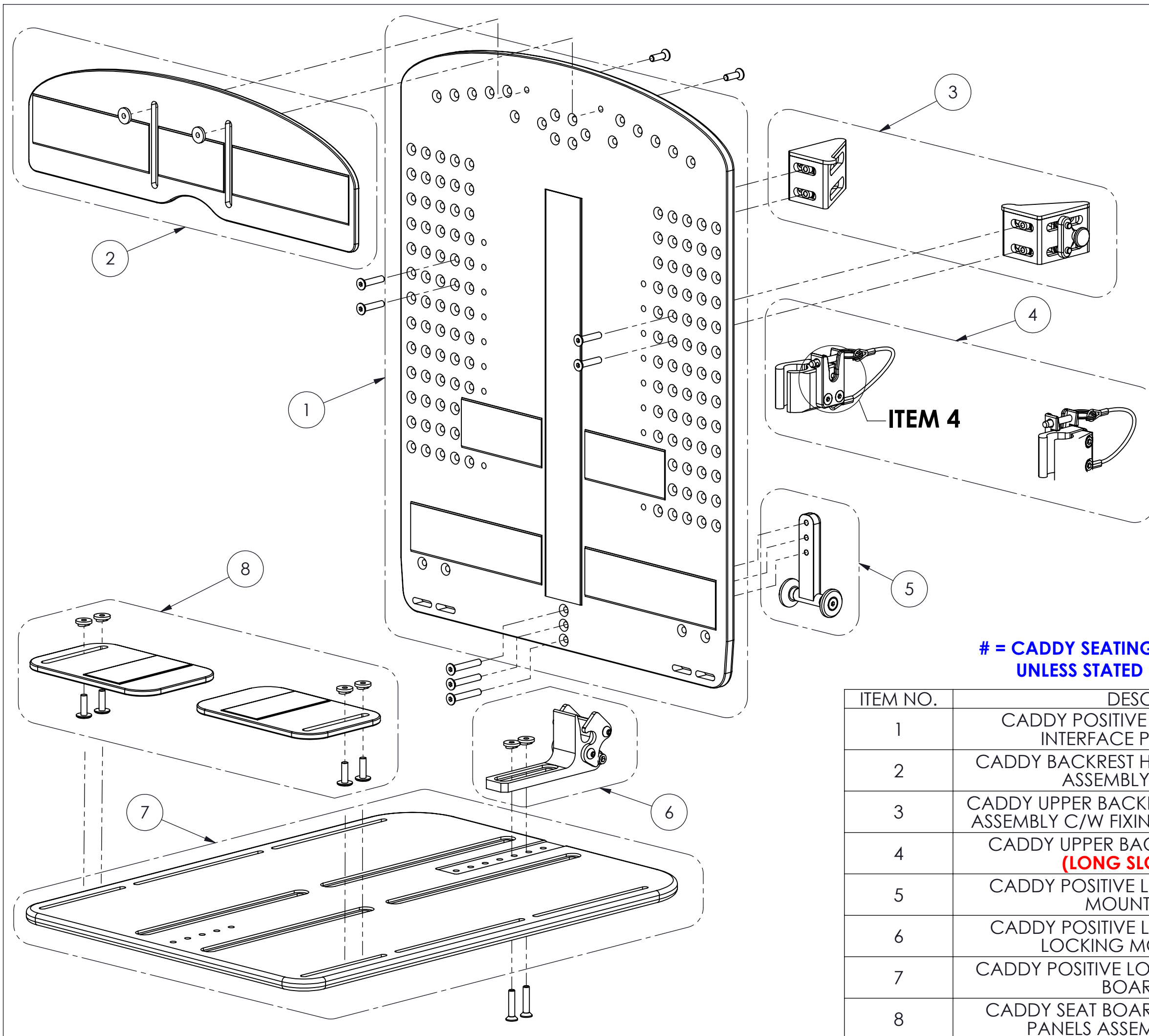

CADDY-SP-DIA-3

SPARE PARTS / OPTIONAL EXTRAS
SEAT BOARD
WHEELCHAIR INTERFACING OPTION FIXINGS
ASSEMBLY

DIAGRAM: 3		VERSION 1
(INTERNAL / EXTERNAL USE)		
DRAWN BY	WMJ	10/10/2017
CHECKED	AM	10/10/2017
APPROVED	WAC	10/10/2017

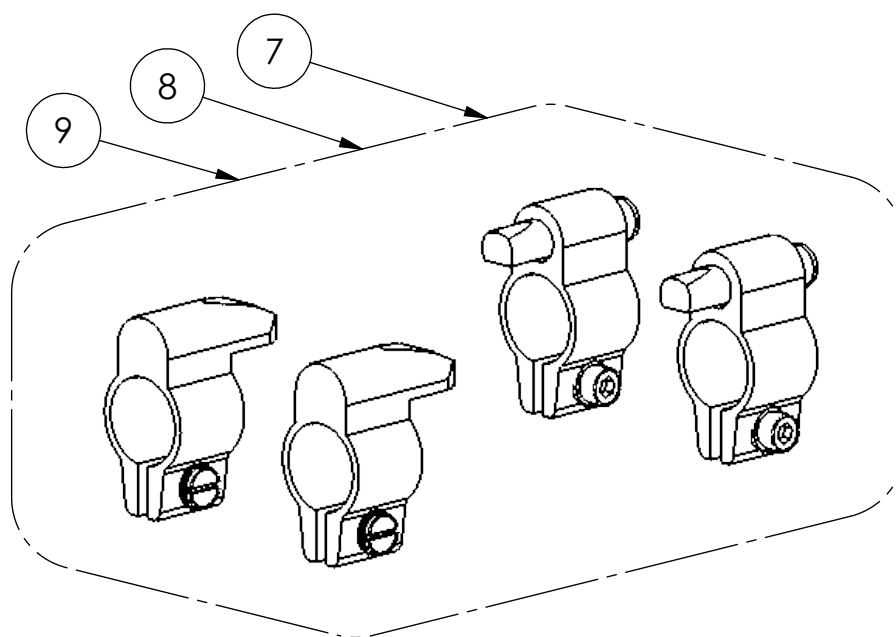
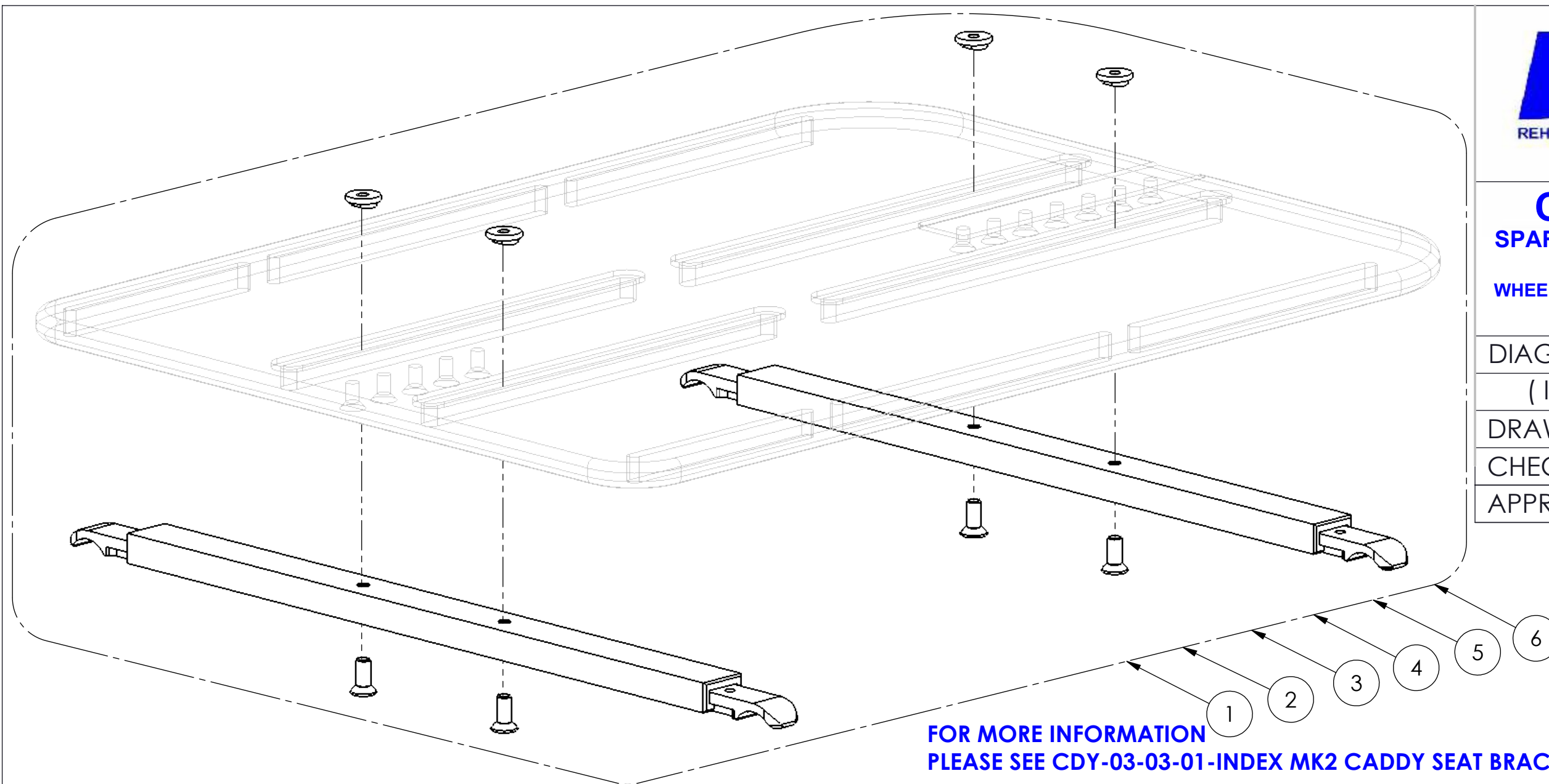

ITEM NO.	DESCRIPTION	PART NUMBER
1	CADDY ADJUSTABLE INTERFACING SEAT CHANNEL & HOOKS C/W FIXINGS (25cm TO 30cm WHEELCHAIR WIDTHS)	CDSP-03-04-140
2	CADDY ADJUSTABLE INTERFACING SEAT CHANNEL & HOOKS C/W FIXINGS (30cm TO 35cm WHEELCHAIR WIDTHS)	CDSP-03-04-190
3	CADDY ADJUSTABLE INTERFACING SEAT CHANNEL & HOOKS C/W FIXINGS (35cm TO 40cm WHEELCHAIR WIDTHS)	CDSP-03-04-240
4	CADDY ADJUSTABLE INTERFACING SEAT CHANNEL & HOOKS C/W FIXINGS (40cm TO 45cm WHEELCHAIR WIDTHS)	CDSP-03-04-280
5	CADDY ADJUSTABLE INTERFACING SEAT CHANNEL & HOOKS C/W FIXINGS (45cm TO 50cm WHEELCHAIR WIDTHS)	CDSP-03-04-340
6	CADDY ADJUSTABLE INTERFACING SEAT CHANNEL & HOOKS C/W FIXINGS (50cm TO 52.5cm WHEELCHAIR WIDTHS)	CDSP-03-04-370
7	LOCK & LATCH TO SUIT 19mm TUBING	LL19
8	LOCK & LATCH TO SUIT 22mm TUBING	LL22
9	LOCK & LATCH TO SUIT 25mm TUBING	LL25

CADDY SEAT BRACKET INDEX

CDY-03-03-01-INDEX

DRAWN BY	WMJ	23/03/2017
CHECKED BY	AM	27/03/2017
APPROVED BY	WAC	27/03/2017

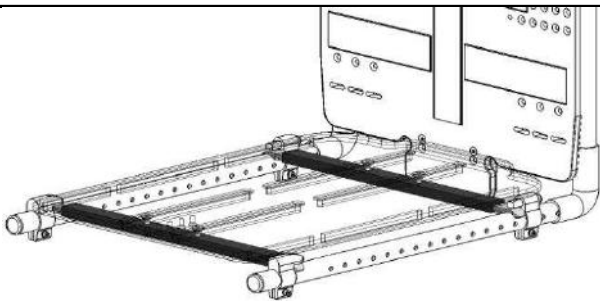

NOTE:

INDENT LINE ON SEAT BOARD ADJUSTER HOOK.
INDICATES MAXIMUM LENGTH HOOK BRACKET CAN
BE ADJUSTED OUT TO.

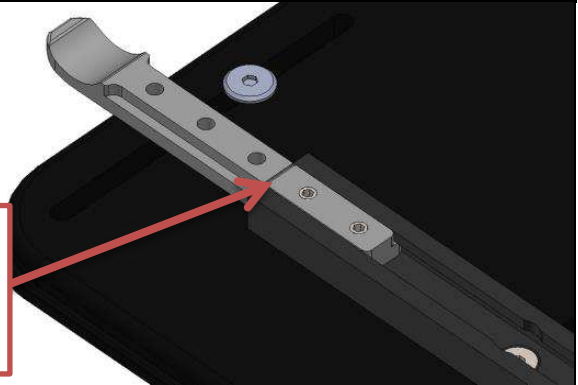

WHEELCHAIR WIDTH	CHANNEL SIZE	HOOK SIZE	CHANNEL GAP NEEDED
25cm / 10"	140mm CHANNEL	5 HOLE HOOK	140mm
27.5cm / 11"	140mm CHANNEL	5 HOLE HOOK	165mm
30cm / 12"	140mm CHANNEL	5 HOLE HOOK	190mm
32.5cm / 13"	190mm CHANNEL	5 HOLE HOOK	215mm
35cm / 14"	190mm CHANNEL	5 HOLE HOOK	240mm
37.5cm / 15"	240mm CHANNEL	5 HOLE HOOK	265mm
40cm / 16"	240mm CHANNEL	5 HOLE HOOK	290mm
42.5cm / 17"	280mm CHANNEL	5 HOLE HOOK	315mm
45cm / 18"	280mm CHANNEL	5 HOLE HOOK	340mm
47.5cm / 19"	340mm CHANNEL	5 HOLE HOOK	365mm
50cm / 20"	370mm CHANNEL	5 HOLE HOOK	390mm
52.5cm / 21"	370mm CHANNEL	5 HOLE HOOK	415mm

140mm CHANNEL	5 HOLE HOOK	SCOPE 25 TO 30cm / 10" TO 12"
190mm CHANNEL	5 HOLE HOOK	SCOPE 30 TO 35cm / 11.5" TO 13.5"
240mm CHANNEL	5 HOLE HOOK	SCOPE 35 TO 40cm / 13.5" TO 16"
280mm CHANNEL	5 HOLE HOOK	SCOPE 40 TO 45cm / 15.5" TO 17.5"
340mm CHANNEL	5 HOLE HOOK	SCOPE 45 TO 50cm / 17.5" TO 19.5"
370mm CHANNEL	5 HOLE HOOK	SCOPE 50 TO 52.5cm / 19.5" TO 21"

CADDY-SP-DIA-4

SPARE PARTS / OPTIONAL EXTRAS
BACKREST CUSHION
OPTIONS
ASSEMBLY

DIAGRAM: 4	VERSION 1
(INTERNAL / EXTERNAL USE)	
DRAWN BY	WMJ 10/10/2017
CHECKED	AM 10/10/2017
APPROVED	WAC 10/10/2017

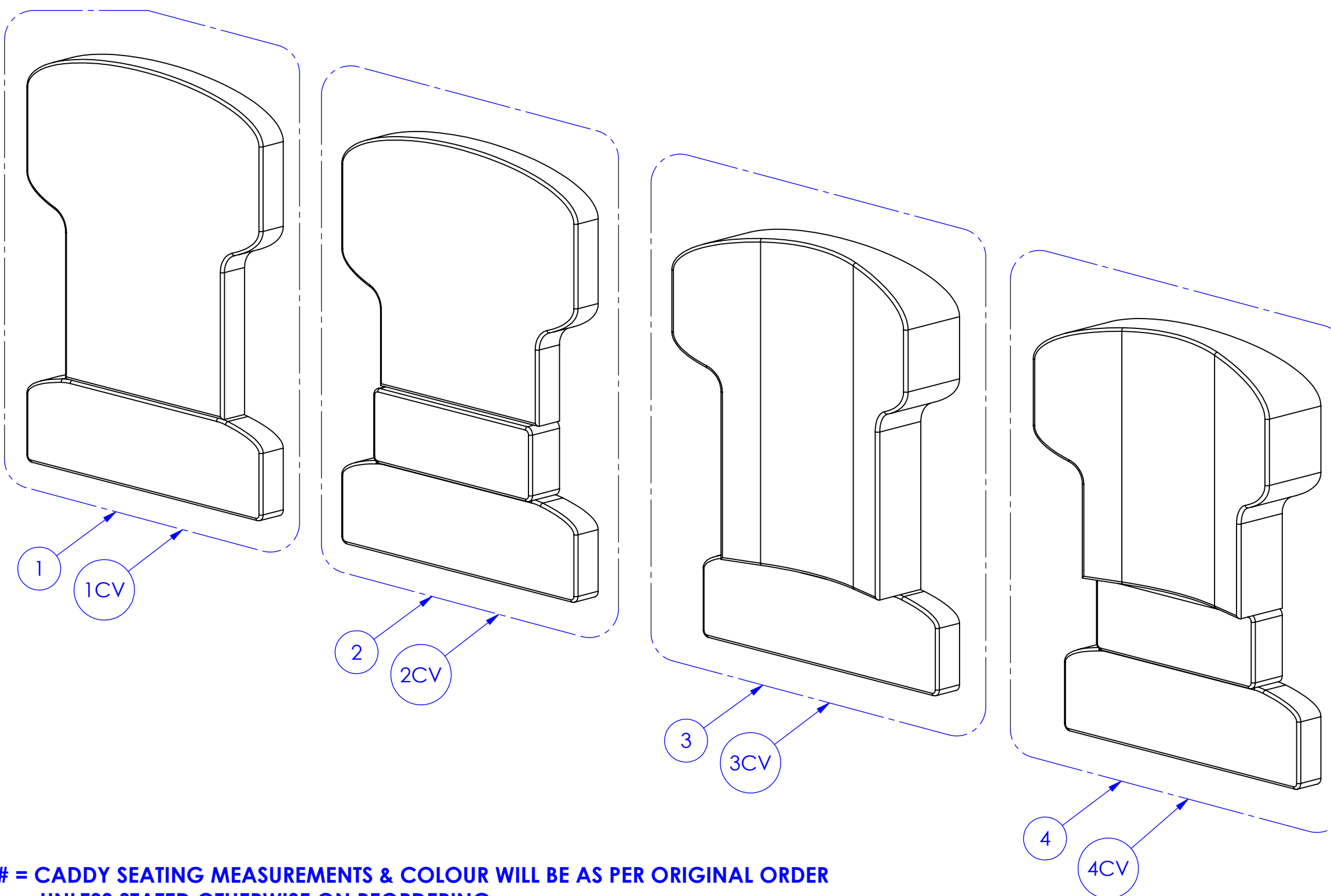

= CADDY SEATING MEASUREMENTS & COLOUR WILL BE AS PER ORIGINAL ORDER
UNLESS STATED OTHERWISE ON REORDERING

ITEM NO	DESCRIPTION	PART NUMBER
1	2 PIECE HEIGHT ADJUSTABLE FLAT CUSHION & COVER. (C/W HEIGHT ADJUSTMENT INFILL PAD)	CDSP-04-08-#
1CV	2 PIECE HEIGHT ADJUSTABLE FLAT CUSHION COVER ONLY . (C/W HEIGHT ADJUSTMENT INFILL PAD COVER)	CDSP-04-08-CV#
2	3 PIECE HEIGHT ADJUSTABLE FLAT CUSHION & COVER. (C/W HEIGHT ADJUSTMENT INFILL PAD)	CDSP-04-09-#
2CV	3 PIECE HEIGHT ADJUSTABLE FLAT CUSHION COVER ONLY . (C/W HEIGHT ADJUSTMENT INFILL PAD COVER)	CDSP-04-09-CV#
3	2 PIECE HEIGHT ADJUSTABLE CURVED CUSHION & COVER. (C/W HEIGHT ADJUSTMENT INFILL PAD)	CDSP-04-10-#
3CV	2 PIECE HEIGHT ADJUSTABLE CURVED CUSHION COVER ONLY . (C/W HEIGHT ADJUSTMENT INFILL PAD COVER)	CDSP-04-10-CV#
4	3 PIECE HEIGHT ADJUSTABLE CURVED CUSHION & COVER. (C/W HEIGHT ADJUSTMENT INFILL PAD)	CDSP-04-11-#
4CV	3 PIECE HEIGHT ADJUSTABLE CURVED CUSHION COVER ONLY . (C/W HEIGHT ADJUSTMENT INFILL PAD COVER)	CDSP-04-11-CV#

CADDY-SP-DIA-5
SPARE PARTS / OPTIONAL EXTRAS
SEAT CUSHION
OPTIONS
ASSEMBLY

DIAGRAM: 5		VERSION 1
(INTERNAL / EXTERNAL USE)		
DRAWN BY	WMJ	10/10/2017
CHECKED	AM	10/10/2017
APPROVED	WAC	10/10/2017

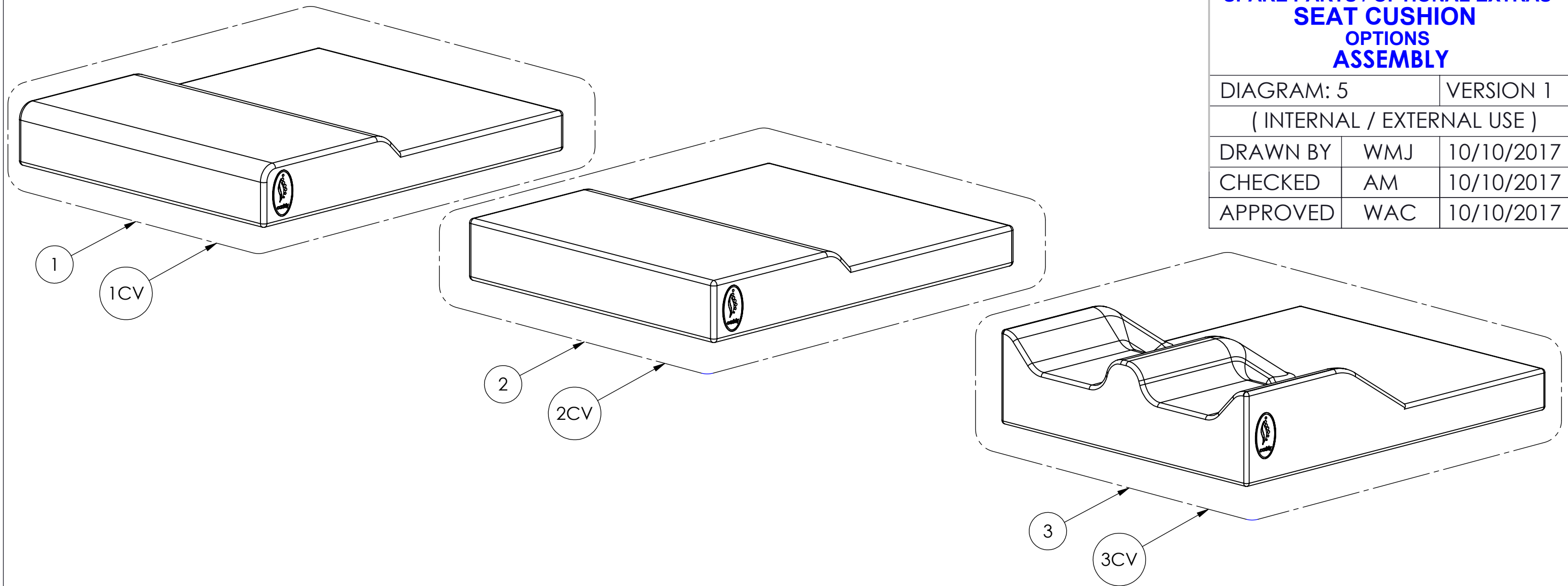

**# = CADDY SEATING MEASUREMENTS & COLOUR WILL BE AS PER ORIGINAL ORDER
UNLESS STATED OTHERWISE ON REORDERING**

ITEM NO.	DESCRIPTION	PART NUMBER
1	FIXED ANTI THRUST SEAT CUSHION C/W COVER	CDSP-03-05-#
1CV	FIXED ANTI THRUST SEAT CUSHION COVER ONLY	CDSP-03-05-CV#
2	ADJUSTABLE ANTI THRUST SEAT CUSHION C/W COVER	CDSP-03-06-#
2CV	ADJUSTABLE ANTI THRUST SEAT CUSHION C/W COVER ONLY	CDSP-03-06-CV#
3	ADJUSTABLE ANTI THRUST CONTOUR SEAT CUSHION C/W COVER	CDSP-03-07-#
3CV	ADJUSTABLE ANTI THRUST CONTOUR SEAT CUSHION COVER ONLY	CDSP-03-07-CV#

CADDY-SP-DIA-6

SPARE PARTS / OPTIONAL EXTRAS
LATERAL THORACIC
FIXED AND SWING AWAY OPTIONS
ASSEMBLY

DIAGRAM: 6 VERSION 1
(INTERNAL / EXTERNAL USE)

DRAWN BY	WMJ	10/10/2017
CHECKED	AM	10/10/2017
APPROVED	WAC	10/10/2017

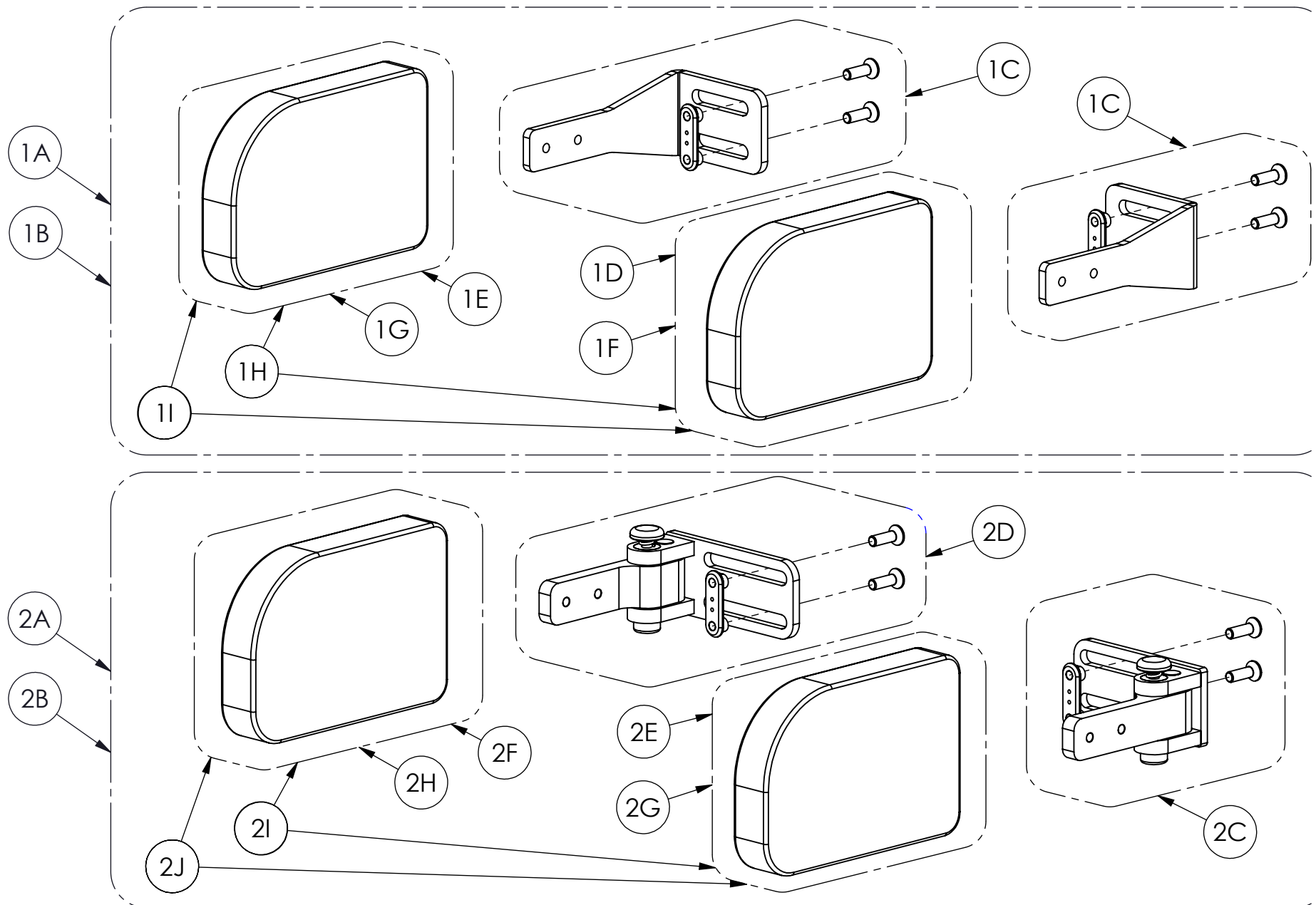

= LATERAL THORACIC PAD MEASUREMENTS WILL BE AS PER
ORIGINAL ORDER UNLESS STATED OTHERWISE ON REORDERING

ITEM NO.	DESCRIPTION	PART NUMBER
1A	LATERAL THORACIC FIXED BRACKET (FLAT PAD) C/W COVER & FIXINGS (SET)	L4-P45-#
1B	LATERAL THORACIC FIXED BRACKET (CURVED PAD) C/W COVER & FIXINGS (SET)	L4-P46-#
1C	LATERAL THORACIC FIXED STRAIGHT BRACKET C/W FIXINGS (UNI LEFT OR RIGHT) ONE SIDE ONLY	L4-P45-00-BRKT
1D	LATERAL THORACIC FIXED FLAT PAD C/W COVER & FIXINGS (LEFT HAND ONLY)	L4-P45-L-#
1E	LATERAL THORACIC FIXED FLAT PAD C/W COVER & FIXINGS (RIGHT HAND ONLY)	L4-P45-R-#
1F	LATERAL THORACIC FIXED CURVED PAD C/W COVER & FIXINGS (LEFT HAND ONLY)	L4-P46-L-#
1G	LATERAL THORACIC FIXED CURVED PAD C/W COVER & FIXINGS (RIGHT HAND ONLY)	L4-P46-R-#
1H	LATERAL THORACIC FIXED FLAT PAD COVER SET ONLY (LEFT AND RIGHT SET)	L4-P45-CV-#
1I	LATERAL THORACIC FIXED CURVED PAD COVER SET ONLY (LEFT AND RIGHT SET)	L4-P46-CV-#
2A	LATERAL THORACIC SWING AWAY BRACKET (FLAT PAD) C/W COVER & FIXINGS (SET)	L4-P47-#
2B	LATERAL THORACIC SWING AWAY BRACKET (CURVED PAD) C/W COVER & FIXINGS (SET)	L4-P48-#
2C	LATERAL THORACIC SWING AWAY BRACKET C/W FIXINGS (LEFT HAND ONLY)	L4-P47-L-BRKT
2D	LATERAL THORACIC SWING AWAY BRACKET C/W FIXINGS (RIGHT HAND ONLY)	L4-P47-R-BRKT
2E	LATERAL THORACIC SWING AWAY FLAT PAD C/W COVER & FIXINGS (LEFT HAND ONLY)	L4-P47-L-#
2F	LATERAL THORACIC SWING AWAY FLAT PAD C/W COVER & FIXINGS (RIGHT HAND ONLY)	L4-P47-R-#
2G	LATERAL THORACIC SWING AWAY CURVED PAD C/W COVER & FIXINGS (LEFT HAND ONLY)	L4-P48-L-#
2H	LATERAL THORACIC SWING AWAY CURVED PAD C/W COVER & FIXINGS (RIGHT HAND ONLY)	L4-P48-R-#
2I	LATERAL THORACIC SWING AWAY FLAT PAD COVER SET ONLY (LEFT AND RIGHT SET)	L4-P47-CV-#
2J	LATERAL THORACIC SWING AWAY CURVED PAD COVER SET ONLY (LEFT AND RIGHT SET)	L4-P48-CV-#

CADDY-SP-DIA-7
SPARE PARTS / OPTIONAL EXTRAS
LATERAL THORACIC
SWING AWAY LINK AND SWING AWAY
WRAP AROUND OPTIONS
ASSEMBLY

DIAGRAM: 7		VERSION 1
(INTERNAL / EXTERNAL USE)		
DRAWN BY	WMJ	10/10/2017
CHECKED	AM	10/10/2017
APPROVED	WAC	10/10/2017

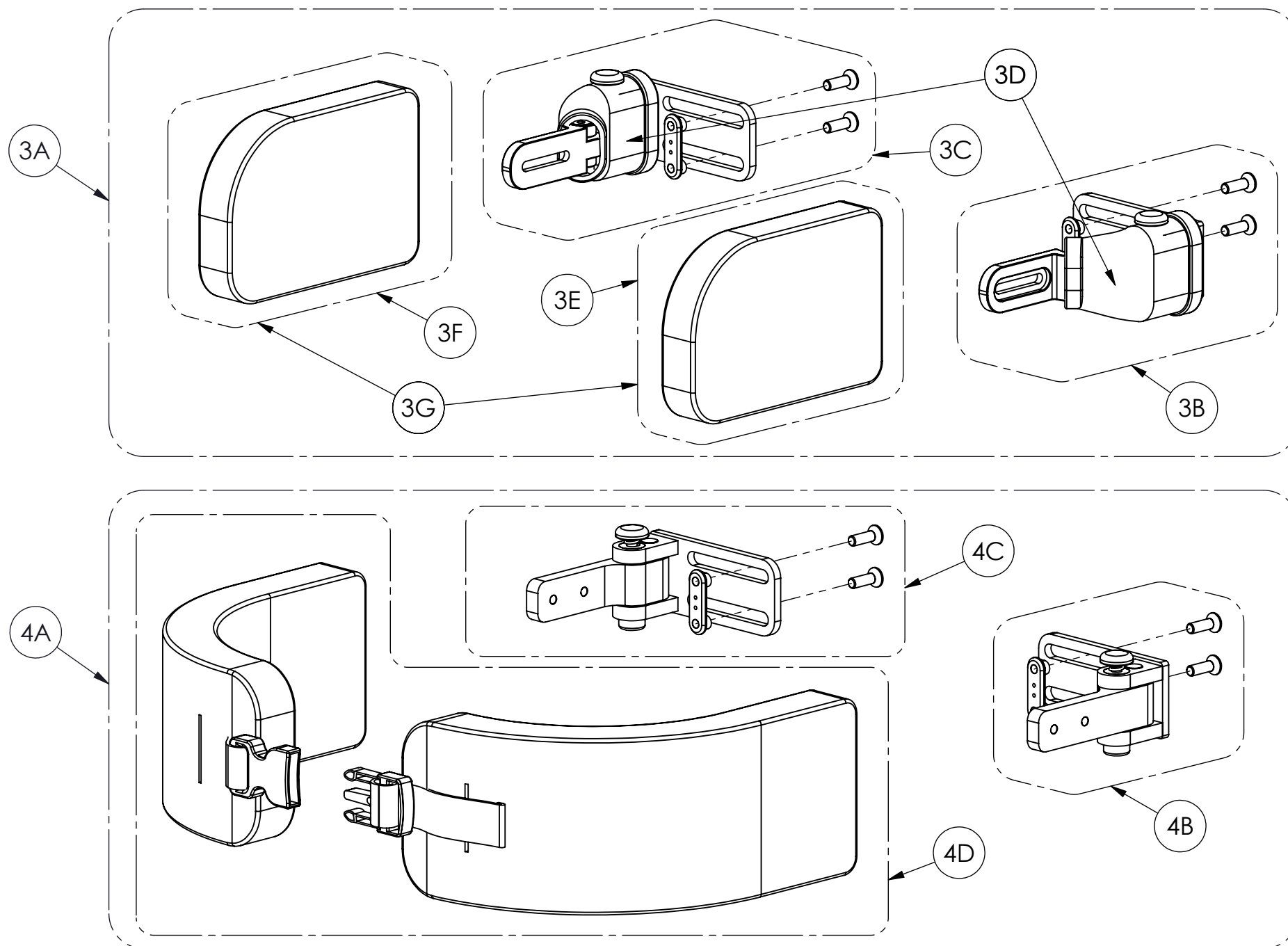

= LATERAL THORACIC PAD MEASUREMENTS WILL BE AS PER ORIGINAL ORDER UNLESS STATED OTHERWISE ON REORDERING

ITEM NO.	DESCRIPTION	PART NUMBER
3A	LATERAL THORACIC SWING AWAY BRACKET WITH 25mm ADJUSTMENT LINK (FLAT PAD) C/W COVER & FIXINGS	L4-P49-#
3B	LATERAL THORACIC SWING AWAY BRACKET WITH 25mm ADJUSTMENT LINK C/W FIXINGS (LEFT HAND ONLY)	L4-49-25-L-BRKT
3C	LATERAL THORACIC SWING AWAY BRACKET WITH 25mm ADJUSTMENT LINK C/W FIXINGS (RIGHT HAND ONLY)	L4-49-25-R-BRKT
3D	LATERAL THORACIC SWING AWAY 25mm LINK COVER SET ONLY (LEFT AND RIGHT HAND SET)	L4-P49-25-SLV
3E	LATERAL THORACIC SWING AWAY LINK FLAT PAD C/W COVER & FIXINGS (LEFT HAND ONLY)	L4-49-FP-L-#
3F	LATERAL THORACIC SWING AWAY LINK FLAT PAD C/W COVER & FIXINGS (RIGHT HAND ONLY)	L4-49-FP-R-#
3G	LATERAL THORACIC SWING AWAY LINK FLAT PAD COVER SET ONLY (LEFT AND RIGHT SET)	L4-49-FP-CV-#
4A	LATERAL THORACIC SWING AWAY BRACKET (FLEXIBLE WRAP AROUND PAD) C/W COVER & FIXINGS	L4-P50-#
4B	LATERAL THORACIC SWING AWAY BRACKET C/W FIXINGS (LEFT HAND ONLY)	L4-P47-L-BRKT
4C	LATERAL THORACIC SWING AWAY BRACKET C/W FIXINGS (RIGHT HAND ONLY)	L4-P47-R-BRKT
4D	LATERAL THORACIC SWING AWAY FLEXIBLE WRAP AROUND PAD C/W COVER & FIXINGS	L4-P50-WP-#

CADDY-SP-DIA-8
SPARE PARTS / OPTIONAL EXTRAS
BACKREST SUPPORT
SHOULDER / TRICEP OPTIONS
ASSEMBLY

DIAGRAM: 8		VERSION 1
(INTERNAL / EXTERNAL USE)		
DRAWN BY	WMJ	10/10/2017
CHECKED	AM	10/10/2017
APPROVED	WAC	10/10/2017

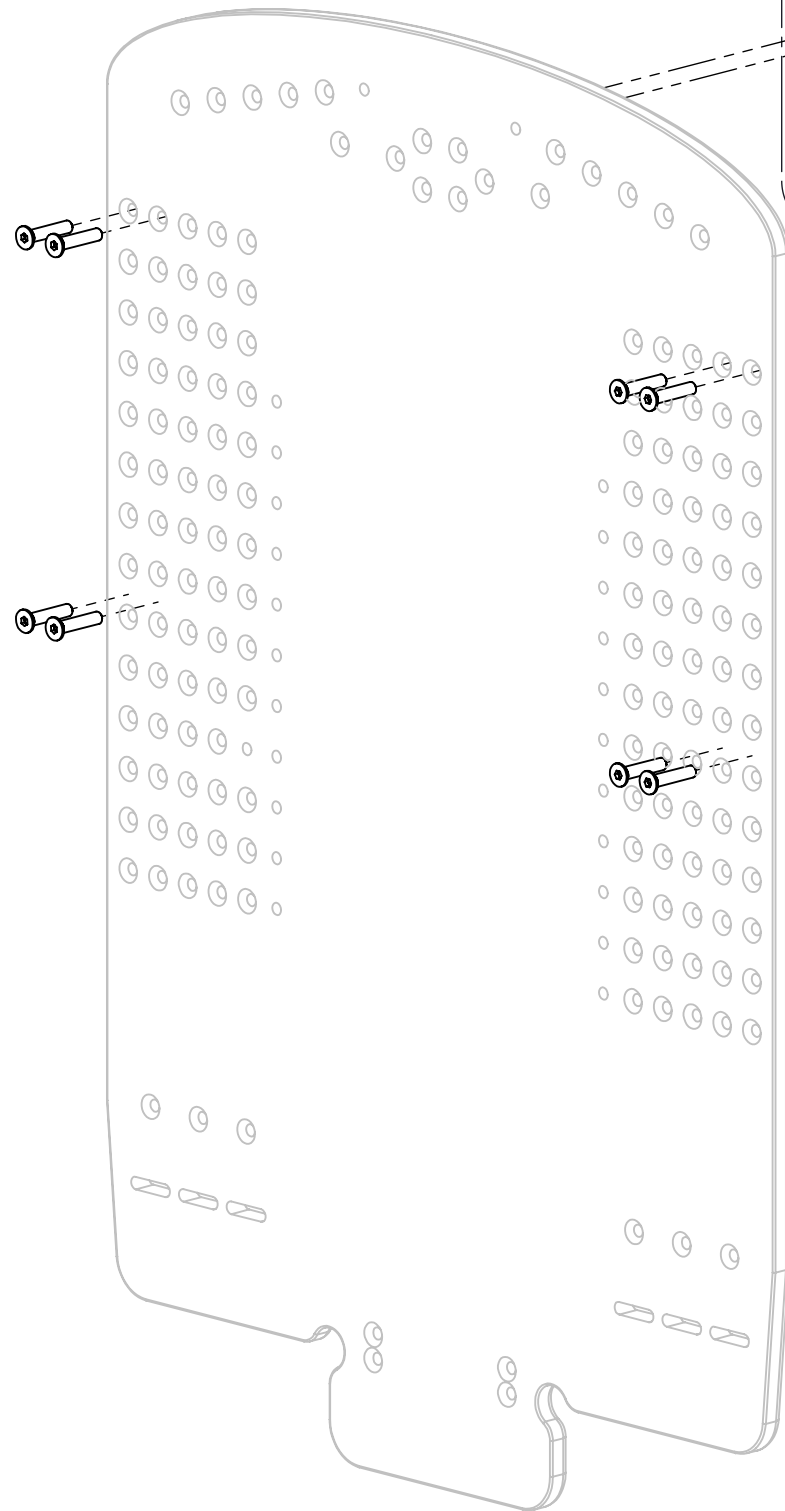

SMALL PAD 7.5cm X 10cm
LARGE PAD 10cm X 15cm

SMALL PAD 7.5cm X 10cm
LARGE PAD 10cm X 15cm

ITEM NO.	DESCRIPTION	PART NUMBER
1	SMALL SHOULDER SUPPORT PAD AND COVER C/W 50mm ADJUSTER (PAIR)	L4-P42-50-S
2	LARGE SHOULDER SUPPORT PAD AND COVER C/W 50mm ADJUSTER (PAIR)	L4-P42-50-L
3	SHOULDER SUPPORT BRACKET C/W 50mm ADJUSTER & FIXINGS (LEFT OR RIGHT)	L4-P42-50-BRKT
4	SMALL TRICEP SUPPORT PAD AND COVER C/W 25mm ADJUSTER (PAIR)	L4-P43-25-S
5	LARGE TRICEP SUPPORT PAD AND COVER C/W 25mm ADJUSTER (PAIR)	L4-P43-25-L
6	SHOULDER SUPPORT BRACKET C/W 25mm ADJUSTER & FIXINGS (LEFT OR RIGHT)	L4-P42-25-BRKT
7	SMALL SHOULDER / TRICEP SUPPORT PAD C/W COVER & FIXINGS (LEFT OR RIGHT)	L4-P42-S-PAD
7CV	SMALL SHOULDER / TRICEP SUPPORT COVER ONLY (PAIR)	L4-P42-S-CV
8	LARGE SHOULDER / TRICEP SUPPORT PAD C/W COVER & FIXINGS (LEFT OR RIGHT)	L4-P42-L-PAD
8CV	LARGE SHOULDER / TRICEP SUPPORT COVER ONLY (PAIR)	L4-P42-L-CV

CADDY-SP-DIA-9

SPARE PARTS / OPTIONAL EXTRAS
PELVIC PAD OPTIONS
ASSEMBLY

DIAGRAM: 9		VERSION 1
(INTERNAL / EXTERNAL USE)		
DRAWN BY	WMJ	10/10/2017
CHECKED	AM	10/10/2017
APPROVED	WAC	10/10/2017

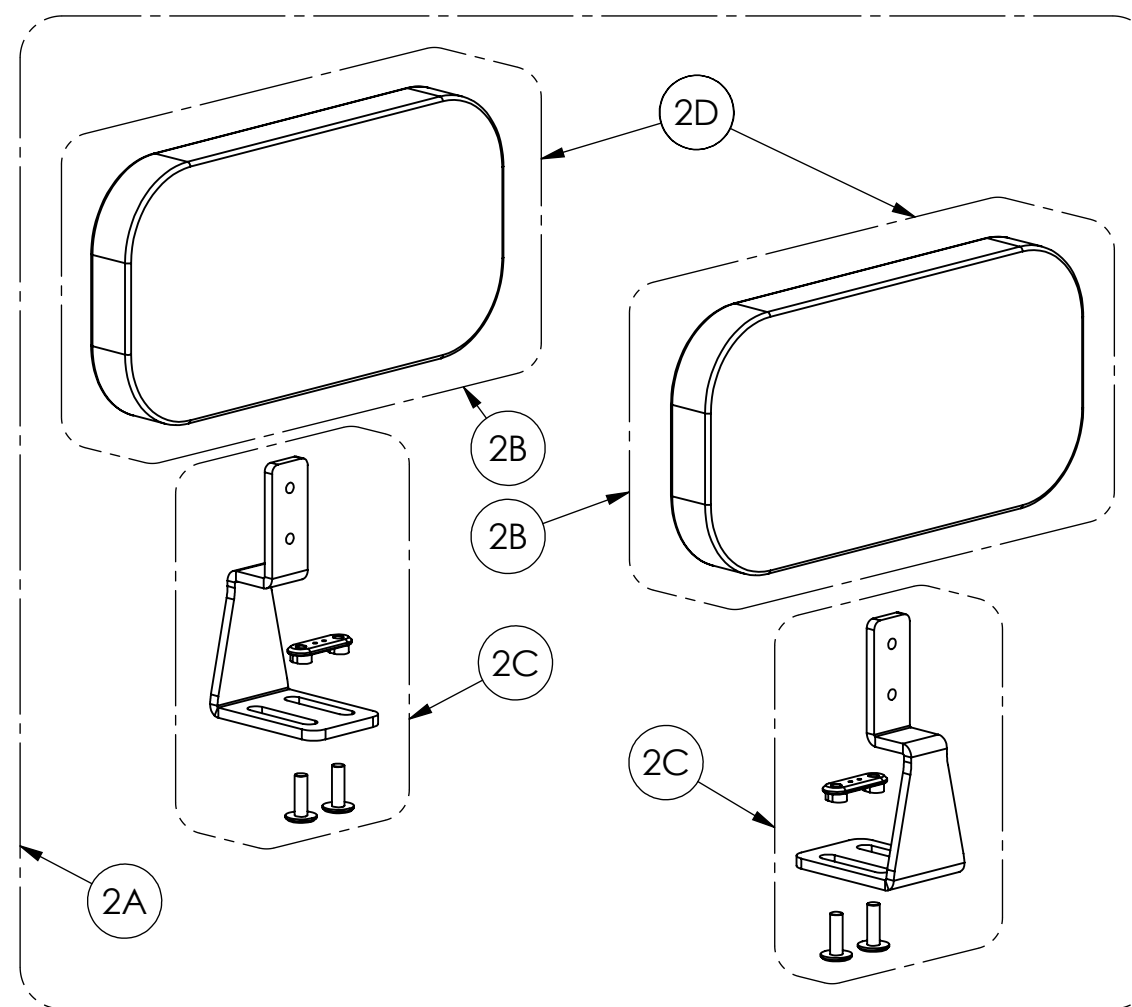
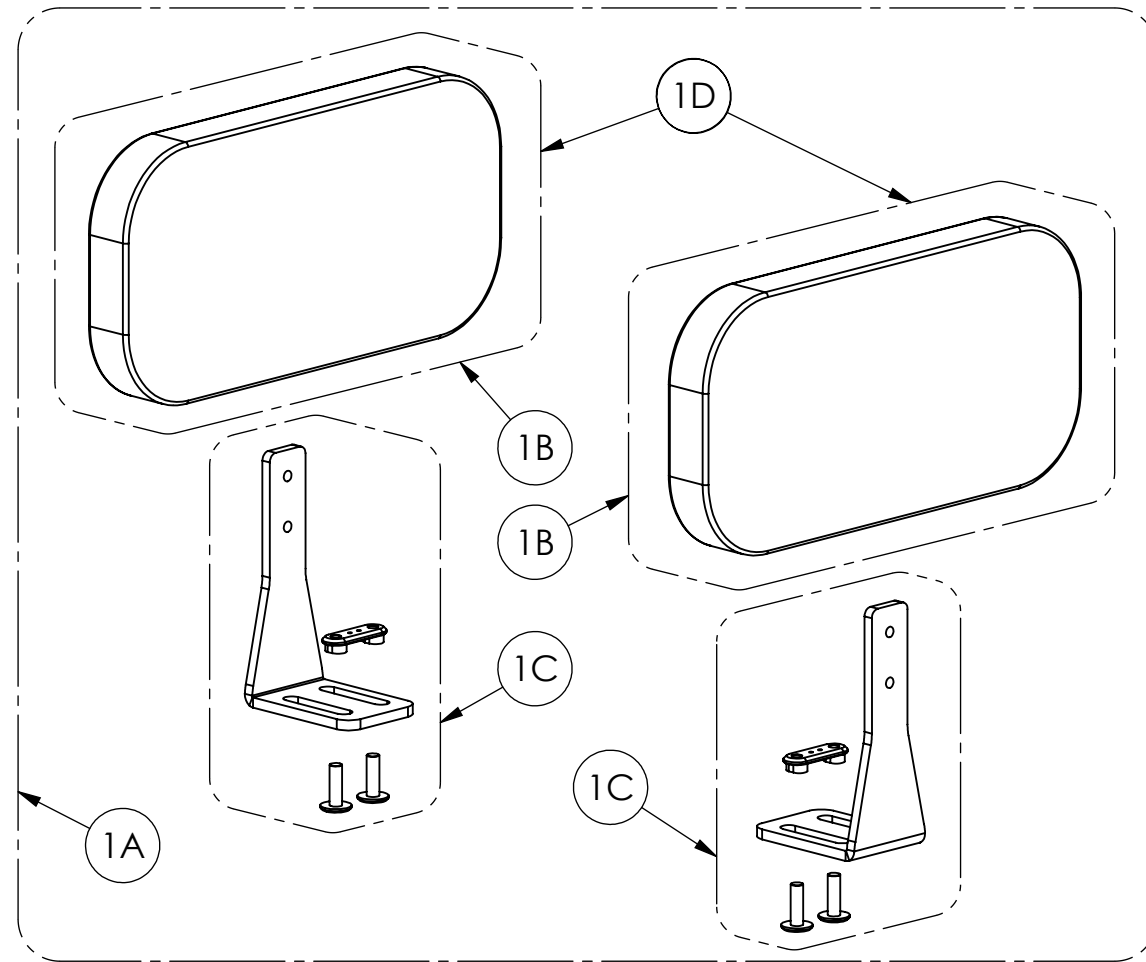

**# = CADDY SEATING MEASUREMENTS AS PER ORIGINAL ORDER
UNLESS STATED OTHERWISE ON REORDERING**

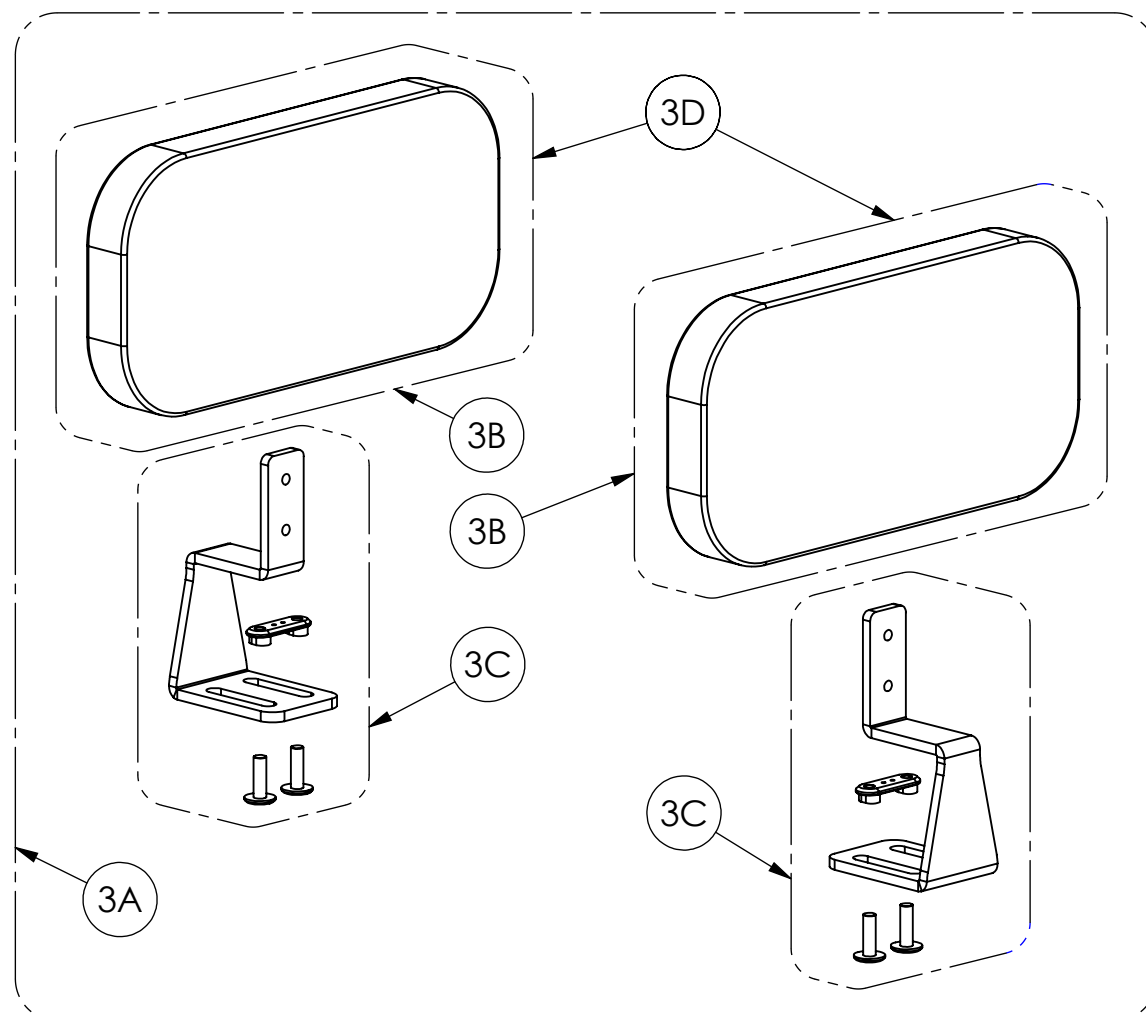

ITEM NO.	DESCRIPTION	PART NUMBER
1A	LATERAL PELVIC PAD STRAIGHT BRACKET C/W COVER & FIXINGS	CDSP-03-08-00-#
1B	LATERAL PELVIC PAD C/W COVER & FIXINGS (UNI LEFT OR RIGHT) ONE SIDE ONLY	CDSP-03-09-#
1C	LATERAL PELVIC STRAIGHT BRACKET C/W FIXINGS (UNI LEFT OR RIGHT) ONE SIDE ONLY	CDSP-03-10-00
1D	LATERAL PELVIC PAD COVER SET ONLY (LEFT AND RIGHT SET)	CDSP-03-08-CV-#
2A	LATERAL PELVIC PAD 5cm OF REDUCTION BRACKET C/W COVER & FIXINGS	CDSP-03-08-25-#
2B	LATERAL PELVIC PAD C/W COVER & FIXINGS (UNI LEFT OR RIGHT) ONE SIDE ONLY	CDSP-03-09-#
2C	LATERAL PELVIC 2.5cm OFF SET BRACKET C/W FIXINGS (UNI LEFT OR RIGHT) ONE SIDE ONLY	CDSP-03-10-25
2D	LATERAL PELVIC PAD COVER SET ONLY (LEFT AND RIGHT SET)	CDSP-03-08-CV-#
3A	LATERAL PELVIC PAD 10cm OF REDUCTION BRACKET C/W COVER & FIXINGS	CDSP-03-08-50-#
3B	LATERAL PELVIC PAD C/W COVER & FIXINGS (UNI LEFT OR RIGHT) ONE SIDE ONLY	CDSP-03-09-#
3C	LATERAL PELVIC 5cm OFF SET BRACKET C/W FIXINGS (UNI LEFT OR RIGHT) ONE SIDE ONLY	CDSP-03-10-50
3D	LATERAL PELVIC PAD COVER SET ONLY (LEFT AND RIGHT SET)	CDSP-03-08-CV-#

CADDY LATERAL PELVIC WIDTH INDEX

CADDY-300-INDEX

(I) CADDY-311
Straight bracket

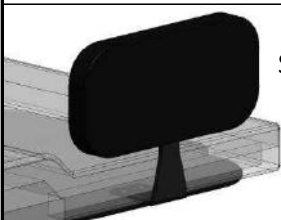

(II) CADDY-312
2.5cm width
reduction bracket

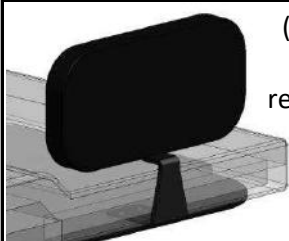

(III) CADDY-313
5cm width
reduction bracket

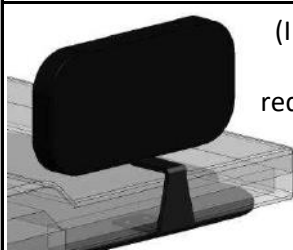

DRAWN BY WMJ 23/03/2017

CHECKED BY AM 27/03/2017

APPROVED BY WAC 27/03/2017

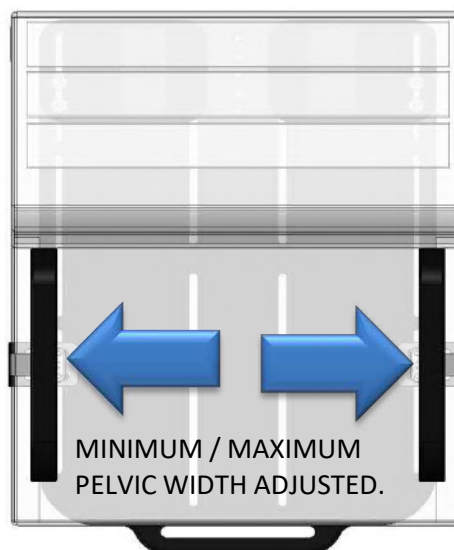

WHEELCHAIR WIDTH	STRAIGHT BRACKET	25mm OFF SET BRACKET	50mm OFF SET BRACKET
25cm / 10"	15cm TO 22.5cm	7.5cm TO 17.5cm	5cm TO 12.5cm
27.5cm / 11"	17.5cm TO 25cm	10cm TO 20cm	7.5cm TO 15cm
30cm / 12"	20cm TO 27.5cm	12.5cm TO 22.5cm	10cm TO 17.5cm
32.5cm / 13"	23.5cm TO 30cm	17.5cm TO 25cm	12.5cm TO 20cm
35cm / 14"	25cm TO 32.5cm	20cm TO 27.5cm	15cm TO 22.5cm
37.5cm / 15"	27.5cm TO 35cm	22.5cm TO 30cm	17.5cm TO 25cm
40cm / 16"	30cm TO 37.5cm	25cm TO 32.5cm	20cm TO 27.5cm
42.5cm / 17"	32.5cm TO 40cm	27.5cm TO 35cm	22.5cm TO 30cm
45cm / 18"	35cm TO 42.5cm	30cm TO 37.5cm	25cm TO 32.5cm
47.5cm / 19"	37.5cm TO 45cm	32.5cm TO 40cm	27.5cm TO 35cm
50cm / 20"	40cm TO 47.5cm	35cm TO 42.5cm	30cm TO 37.5cm

CADDY-SP-DIA-10

SPARE PARTS / OPTIONAL EXTRAS KNEE ADDUCTOR OPTIONS ASSEMBLY

DIAGRAM: 10	VERSION 1
(INTERNAL / EXTERNAL USE)	
DRAWN BY	WMJ 10/10/2017
CHECKED	AM 10/10/2017
APPROVED	WAC 10/10/2017

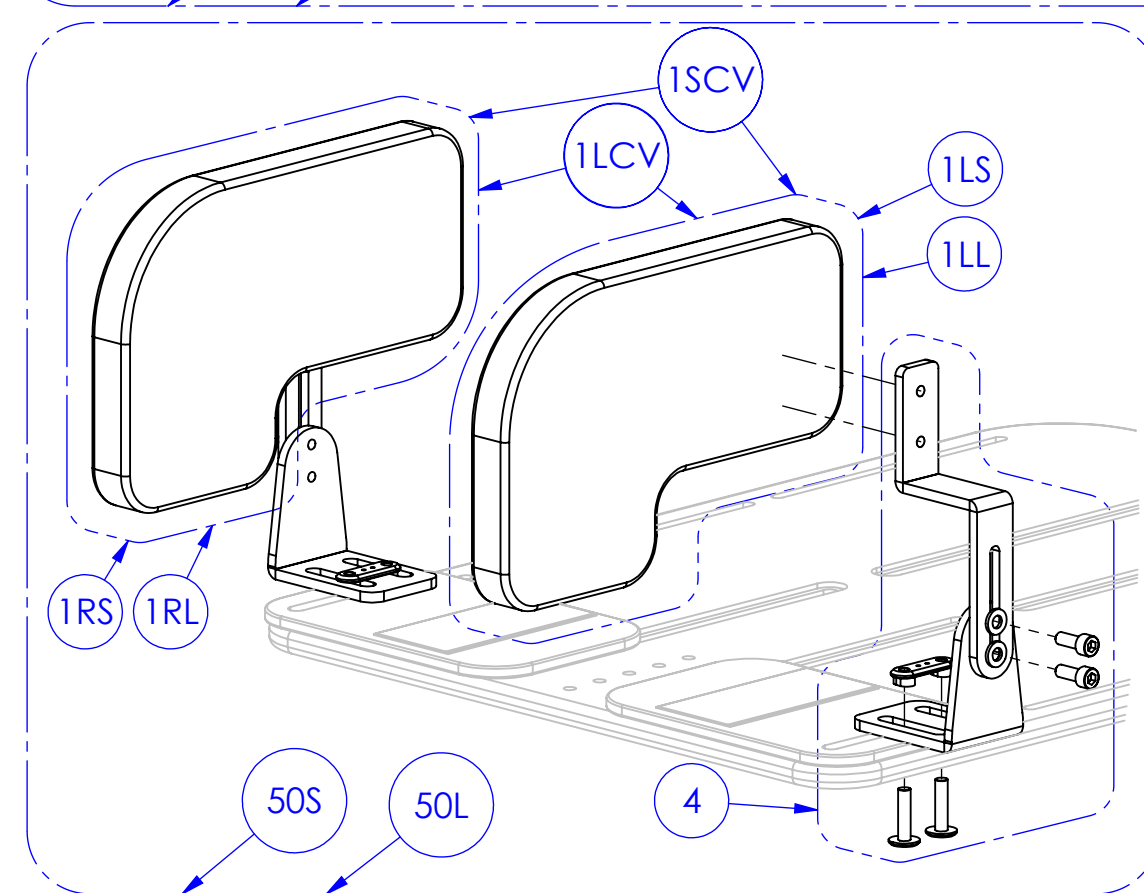
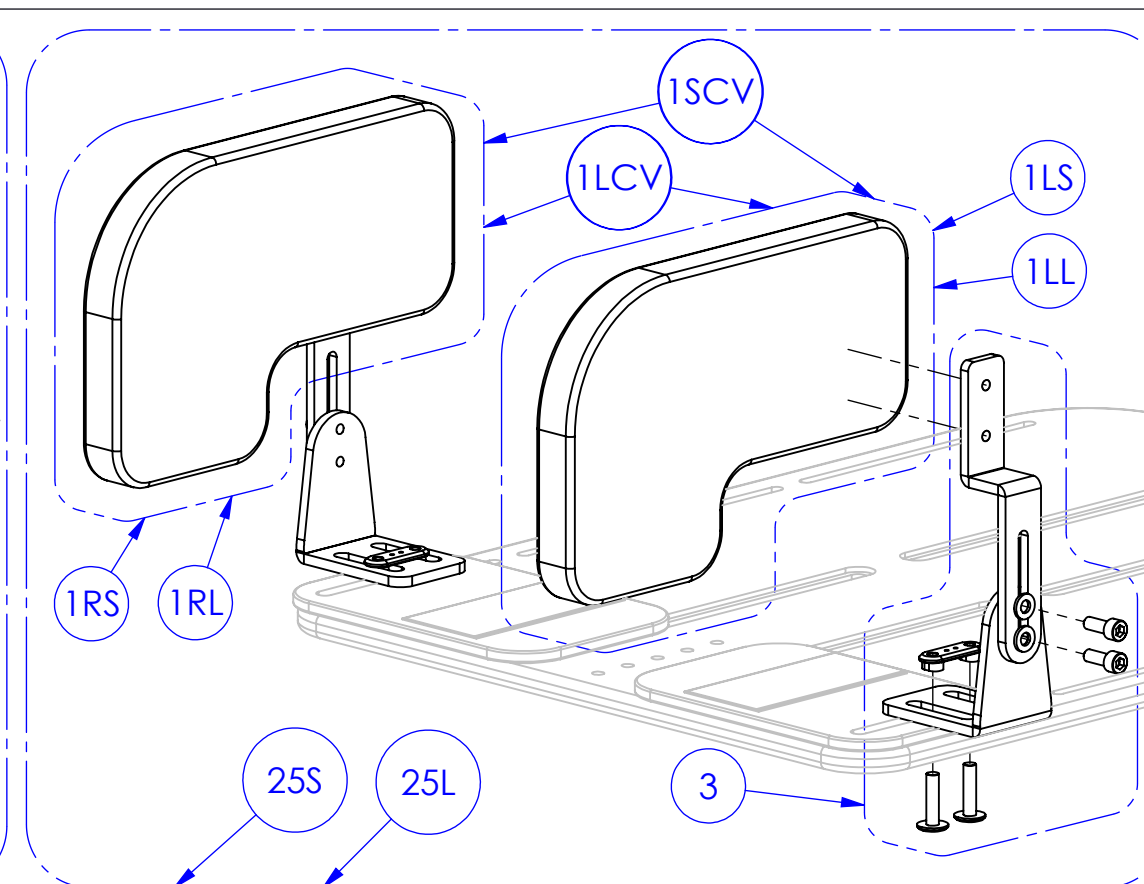
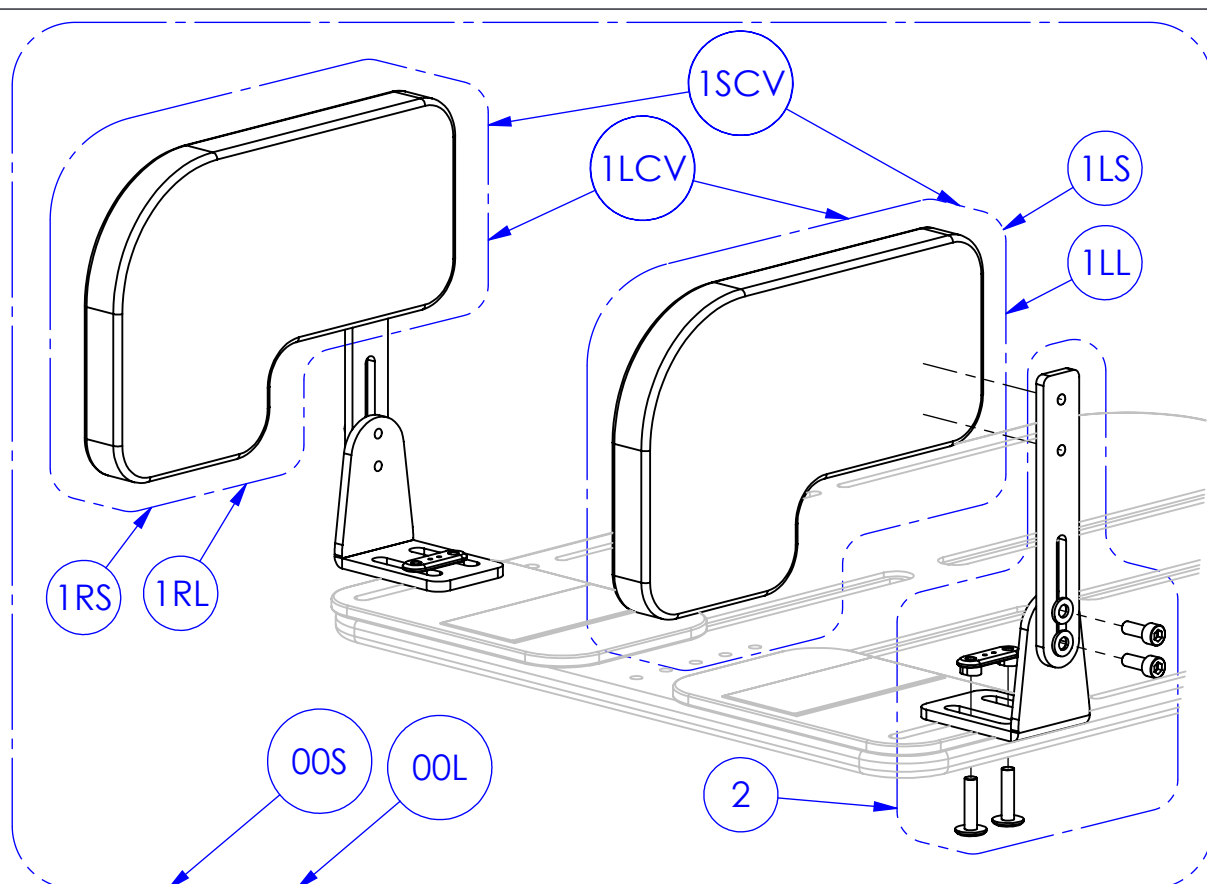

ITEM NO.	DESCRIPTION	PART NUMBER
1LS	KNEE ADDUCTOR SMALL LEFT HAND PAD ONLY C/W COVER & FIXINGS	CDSP-03-11-SPL
1RS	KNEE ADDUCTOR SMALL RIGHT HAND PAD ONLY C/W COVER & FIXINGS	CDSP-03-11-SPR
1SCV	KNEE ADDUCTOR SMALL PAD COVER SET ONLY	CDSP-03-11-SP-CV
1LL	KNEE ADDUCTOR LARGE LEFT HAND PAD ONLY C/W COVER & FIXINGS	CDSP-03-11-LPL
1RL	KNEE ADDUCTOR LARGE RIGHT HAND PAD ONLY C/W COVER & FIXINGS	CDSP-03-11-LPR
1LCV	KNEE ADDUCTOR LARGE PAD COVER SET ONLY	CDSP-03-11-LP-CV
00S	KNEE ADDUCTOR SMALL PAD AND COVER C/W STRAIGHT BRACKET AND FIXINGS (SET)	CDSP-03-12-S
00L	KNEE ADDUCTOR LARGE PAD AND COVER C/W STRAIGHT BRACKET AND FIXINGS (SET)	CDSP-03-12-L
2	KNEE ADDUCTOR STRAIGHT BRACKET AND FIXINGS (ONE SIDE ONLY)	CDSP-03-12
25S	KNEE ADDUCTOR SMALL PAD AND COVER C/W 2.5cm WIDTH REDUCTION (5cm OF REDUCTION) BRACKET AND FIXINGS (SET)	CDSP-03-13-S
25L	KNEE ADDUCTOR LARGE PAD AND COVER C/W 2.5cm WIDTH REDUCTION (5cm OF REDUCTION) BRACKET AND FIXINGS (SET)	CDSP-03-13-L
3	KNEE ADDUCTOR 2.5cm BRACKET AND FIXINGS (ONE SIDE ONLY)	CDSP-03-13
50S	KNEE ADDUCTOR SMALL PAD AND COVER C/W 5cm WIDTH REDUCTION (10cm OF REDUCTION) BRACKET AND FIXINGS (SET)	CDSP-03-14-S
50L	KNEE ADDUCTOR LARGE PAD AND COVER C/W 5cm WIDTH REDUCTION (10cm OF REDUCTION) BRACKET AND FIXINGS (SET)	CDSP-03-14-L
4	KNEE ADDUCTOR 5cm BRACKET AND FIXINGS (ONE SIDE ONLY)	CDSP-03-14

PAD SIZES

(PAD DEPTH x SHELF LENGTH x FEMUR HEIGHT x FIBULA DEPTH)

SMALL PAD = 20cm x 12.5cm x 7.5cm x 7.5cm

LARGE PAD = 22.5cm x 12.5cm x 10cm x 10cm

CADDY-SP-DIA-11
SPARE PARTS / OPTIONAL EXTRAS
HEADREST MOUNTING OPTIONS
ASSEMBLY

DIAGRAM: 11		VERSION 1
(INTERNAL / EXTERNAL USE)		
DRAWN BY	WMJ	10/10/2017
CHECKED	AM	10/10/2017
APPROVED	WAC	10/10/2017

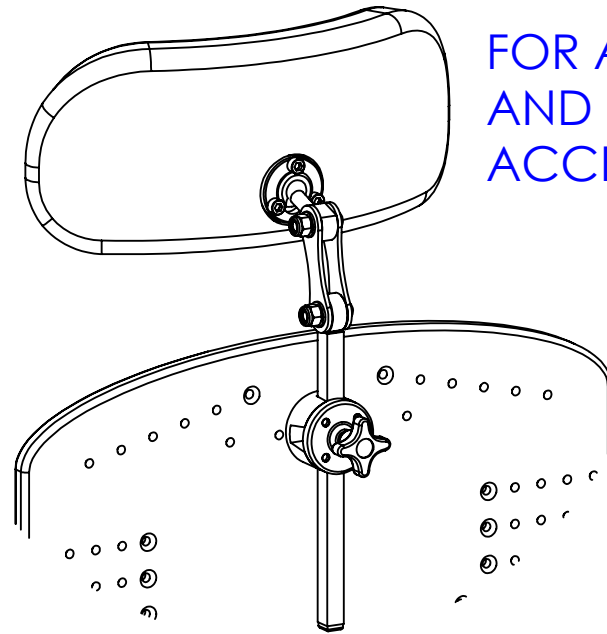

FOR ALTERNATIVE / REPLACEMENT HEADREST
AND COVERS PLEASE VIEW RMS PRODUCT &
ACCESSORIES CATALOGUE

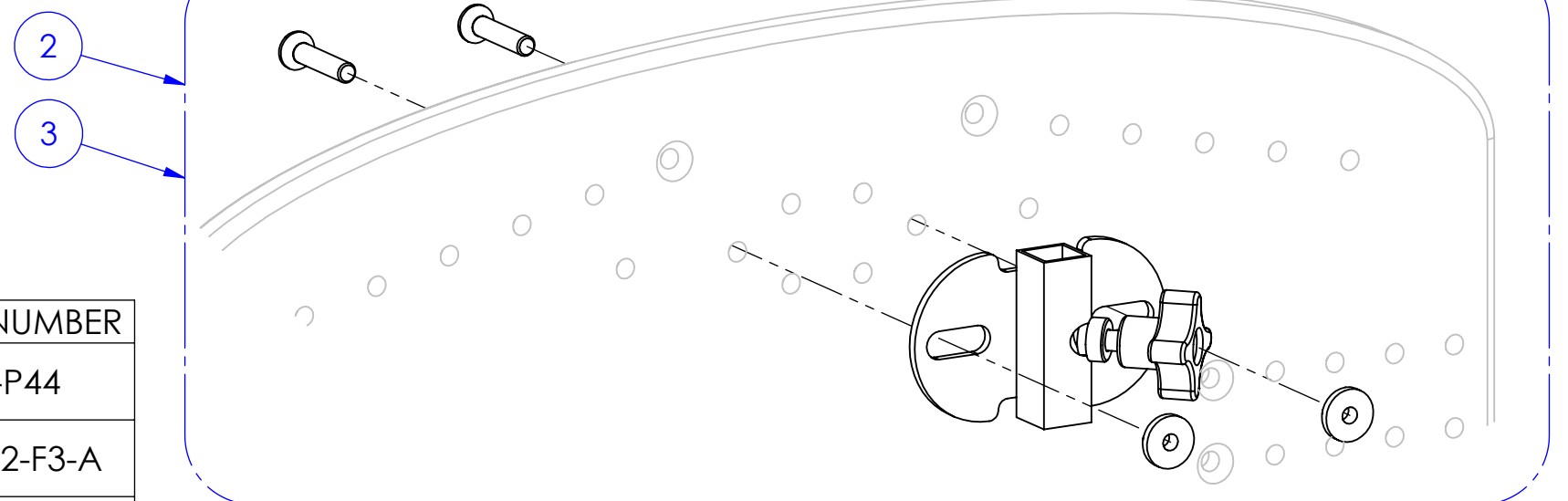
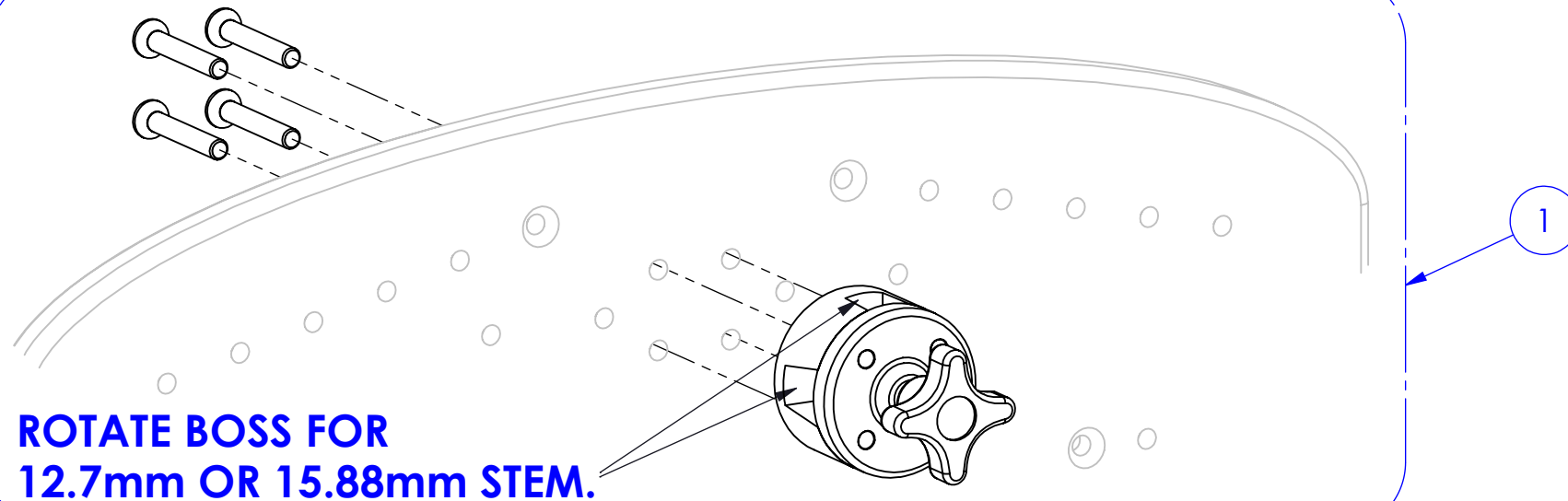

ITEM NO.	DESCRIPTION	PART NUMBER
1	HEADREST BOSS FITS 12.7 & 15.88 SQUARE STEMS C/W FIXINGS	L4-P44
2	2 POINT HEADREST STEM MOUNT TO SUIT 12.7mm STEMS C/W FIXINGS	L4-P52-F3-A
3	2 POINT HEADREST STEM MOUNT TO SUIT 15.88mm STEMS C/W FIXINGS	L4-P52-F3-B

CADDY-SP-DIA-12
SPARE PARTS / OPTIONAL EXTRAS
ABDUCTOR OPTIONS
ASSEMBLY

DIAGRAM: 12		VERSION 1
(INTERNAL / EXTERNAL USE)		
DRAWN BY	WMJ	10/10/2017
CHECKED	AM	10/10/2017
APPROVED	WAC	10/10/2017

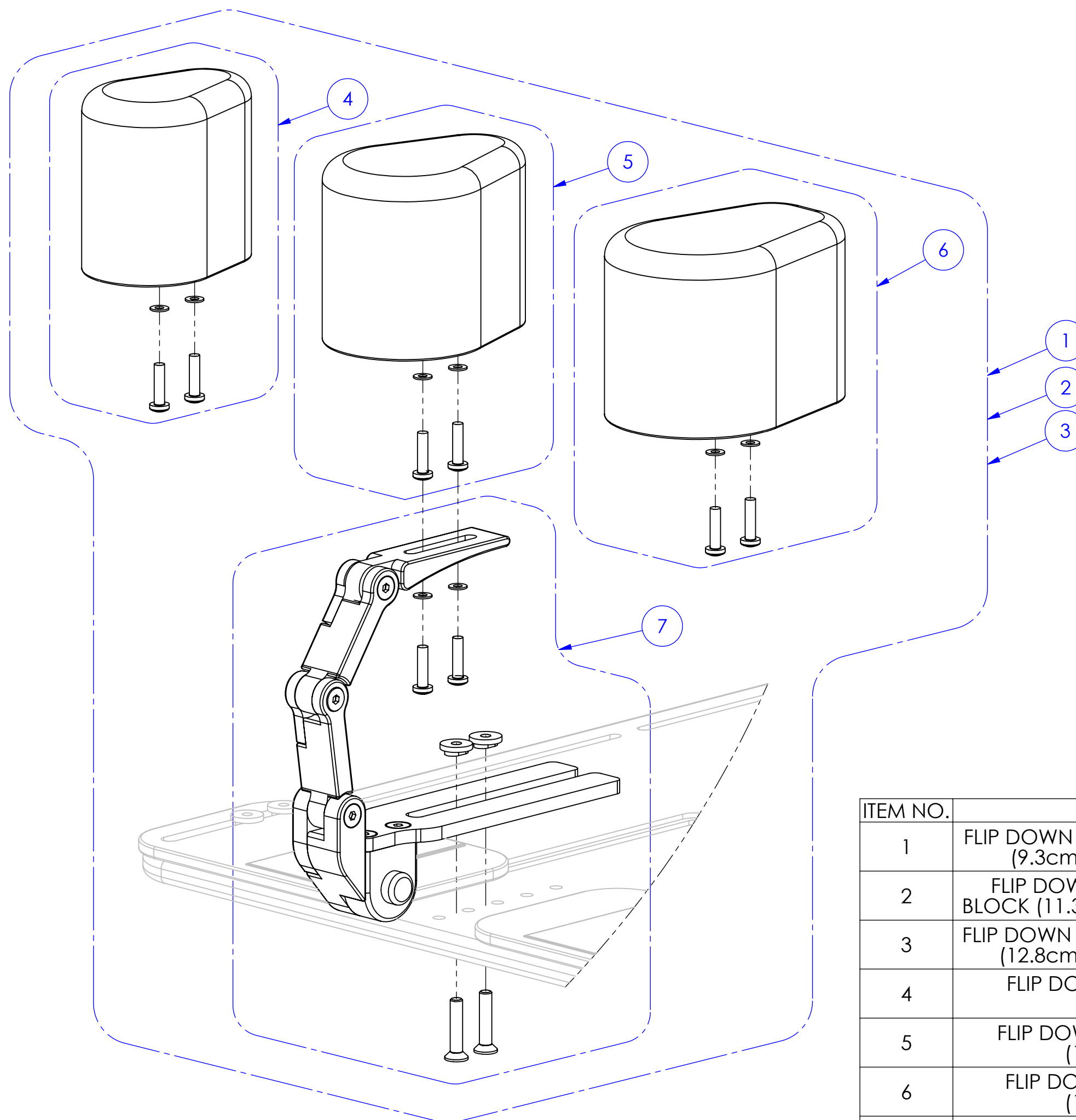

ITEM NO.	DESCRIPTION	PART NUMBER
1	FLIP DOWN ABDUCTOR BRACKET WITH SMALL PU BLOCK (9.3cm x 6.6cm x 9cm (L x W x H) C/W FIXINGS	L3-P50-S
2	FLIP DOWN ABDUCTOR BRACKET WITH MEDIUM PU BLOCK (11.3cm x 8.2cm x 10cm (L x W x H) C/W FIXINGS	L3-P50-M
3	FLIP DOWN ABDUCTOR BRACKET WITH LARGE PU BLOCK (12.8cm x 9.1cm x 10cm (L x W x H) C/W FIXINGS	L3-P50-L
4	FLIP DOWN ABDUCTOR SMALL PU BLOCK ONLY (9.3cm x 6.6cm x 9cm (L x W x H)	L3-P50-SPUB
5	FLIP DOWN ABDUCTOR MEDIUM PU BLOCK ONLY (11.3cm x 8.2cm x 10cm (L x W x H)	L3-P50-MPUB
6	FLIP DOWN ABDUCTOR LARGE PU BLOCK ONLY (12.8cm x 9.1cm x 10cm (L x W x H)	L3-P50-LPUB
7	FLIP DOWN ABDUCTOR BRACKET C/W FIXINGS	L3-P50-BRKT

CADDY-SP-DIA-13
SPARE PARTS / OPTIONAL EXTRAS
SEAT INTERFACE OPTIONS
ASSEMBLY

DIAGRAM: 13		VERSION 1
(INTERNAL / EXTERNAL USE)		
DRAWN BY	WMJ	18/04/2018
CHECKED	AM	18/04/2018
APPROVED	WAC	18/04/2018

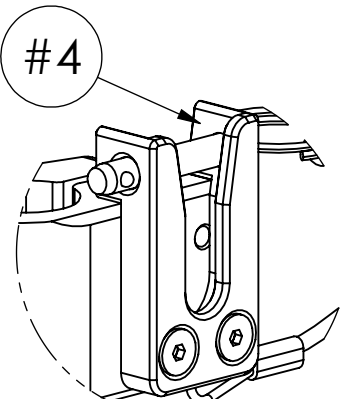
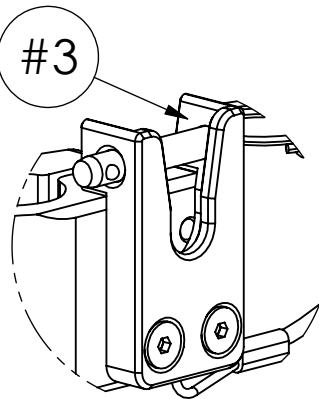
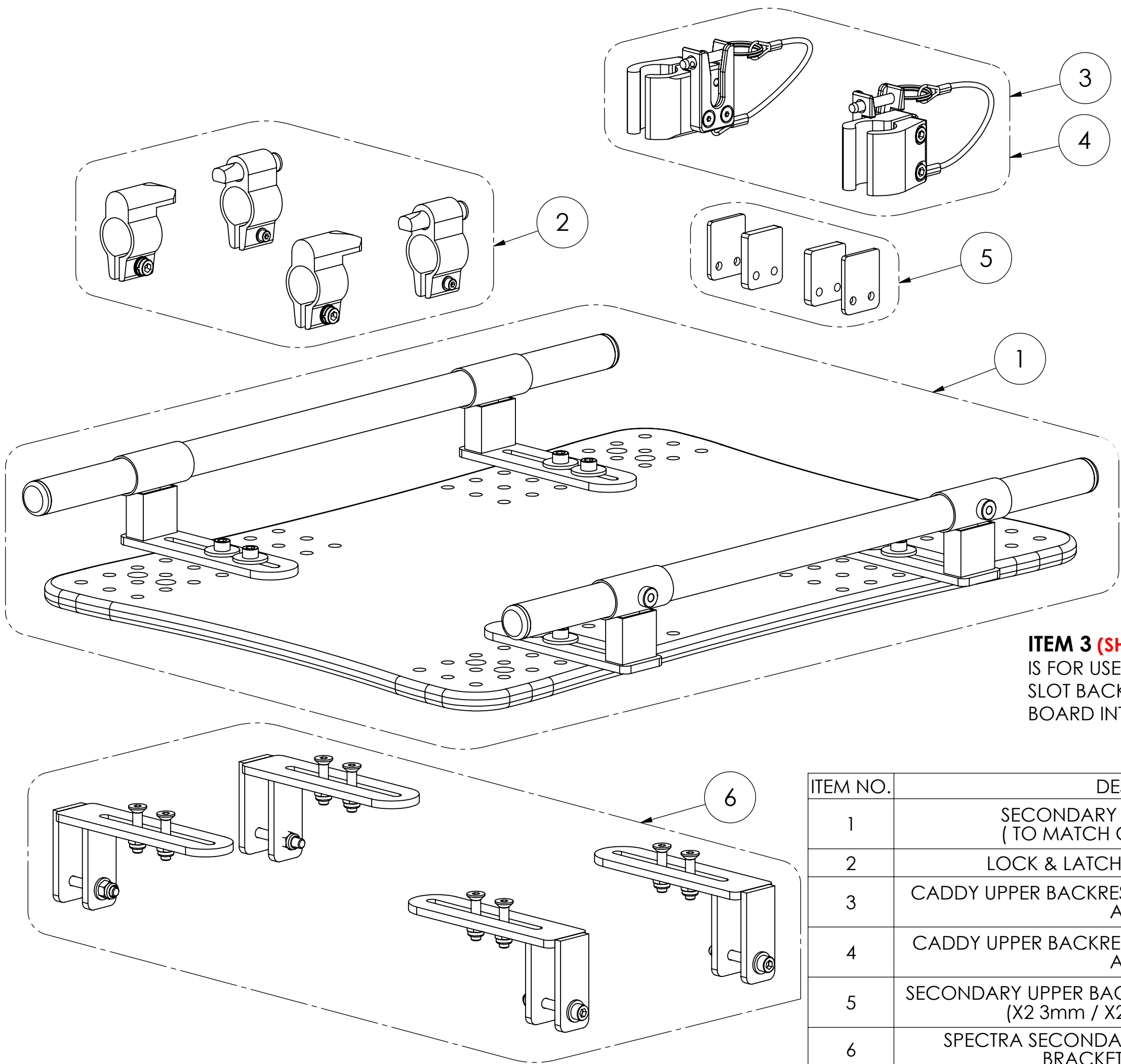

ITEM 3 (SHORT SLOT)
IS FOR USE WITH STANDARD
SLOT BACKREST & SEAT
BOARD INTERFACE **(ONLY)**

ITEM 4 (LONG SLOT)
IS FOR USE WITH STANDARD
SLOT BACKREST & SEAT
BOARD INTERFACE **(ONLY)**

ITEM NO.	DESCRIPTION	PART NUMBER
1	SECONDARY SEAT RAIL INTERFACE (TO MATCH CADDY SEAT BOARD)	L3-P58-01
2	LOCK & LATCH TO SUIT 22mm TUBING	LL22
3	CADDY UPPER BACKREST FRAME CLAMP (SHORT SLOT) ASSEMBLY	CDSP-04-05-STD
4	CADDY UPPER BACKREST FRAME CLAMP (LONG SLOT) ASSEMBLY	CDSP-04-05-POV
5	SECONDARY UPPER BACKREST FRAME CLAMP SPACERS (X2 3mm / X2 6mm) C/W FIXINGS	CDSP-04-05-3-6-S
6	SPECTRA SECONDARY SEAT FRAME MOUNTING BRACKETS (C/W FIXINGS)	L3-P59-01

CADDY-SP-DIA-14

SPARE PARTS / OPTIONAL EXTRAS
BACKREST INTERFACE OPTIONS
ASSEMBLY

DIAGRAM: 14	VERSION 1
(INTERNAL / EXTERNAL USE)	
DRAWN BY	WMJ 18/04/2018
CHECKED	AM 18/04/2018
APPROVED	WAC 18/04/2018

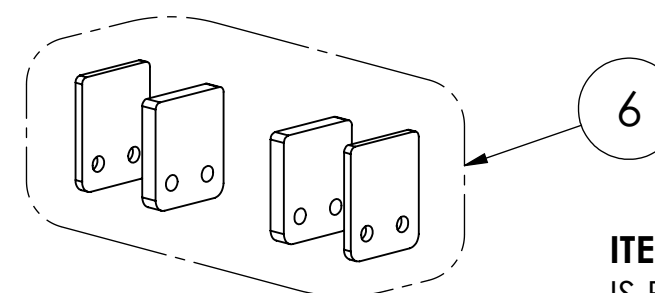
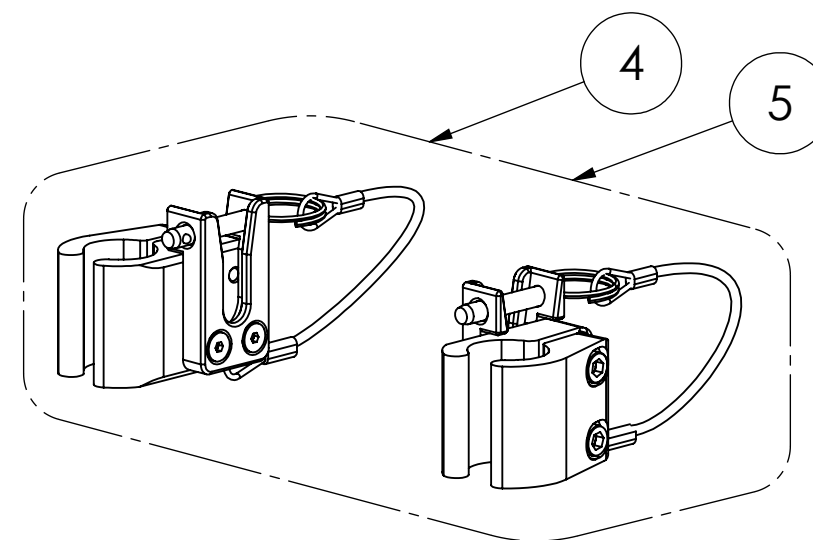
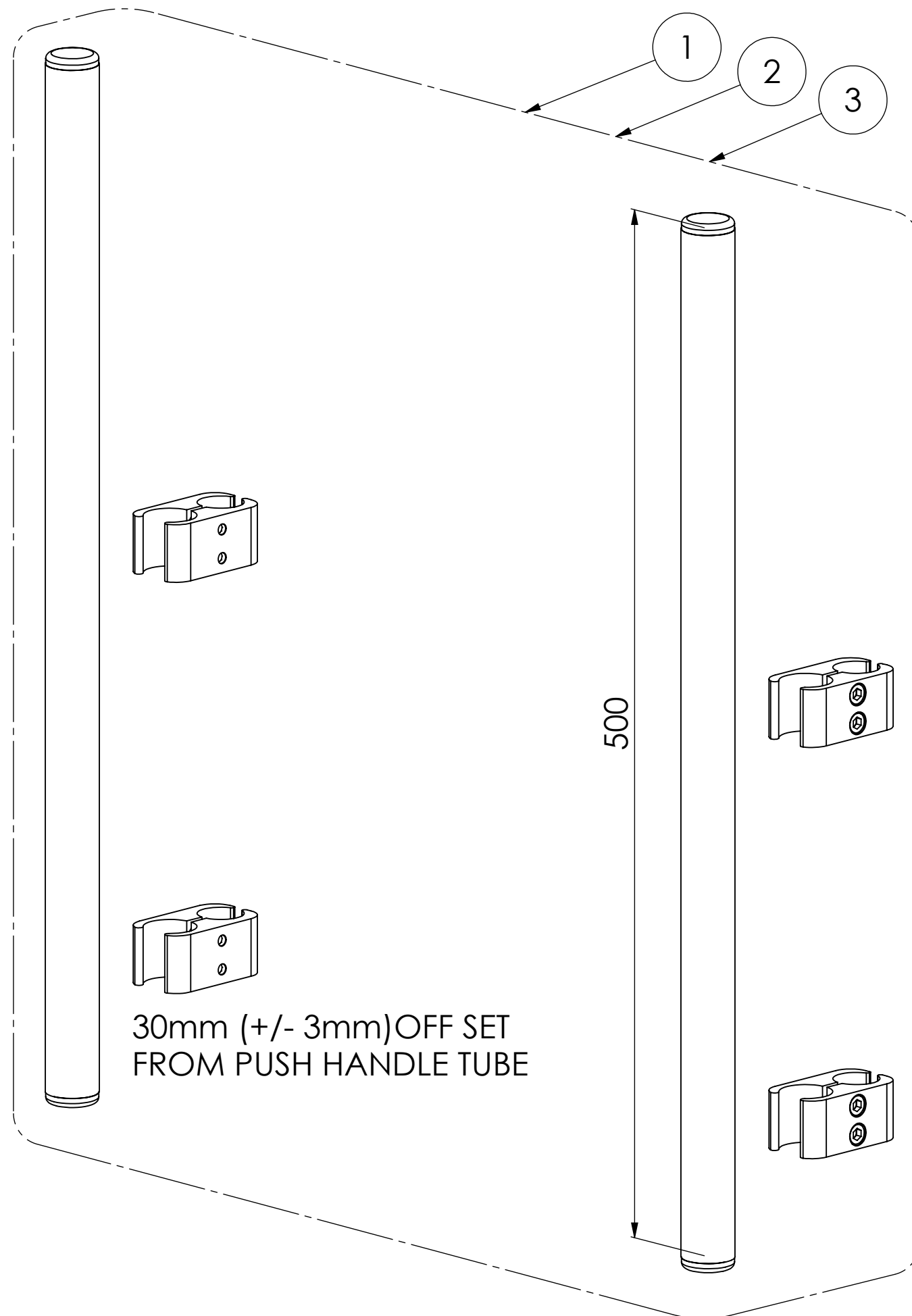

ITEM 4 (SHORT SLOT)
IS FOR USE WITH STANDARD
SLOT BACKREST & SEAT
BOARD INTERFACE **(ONLY)**

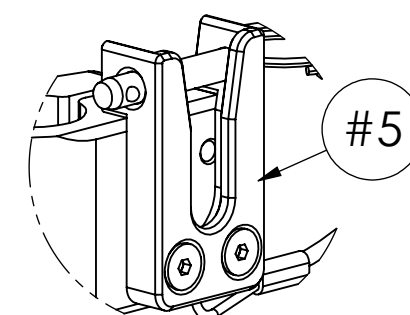
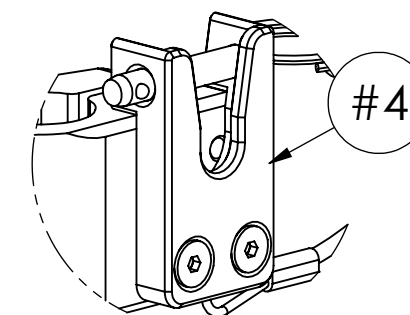

ITEM 5 (LONG SLOT)
IS FOR USE WITH STANDARD
SLOT BACKREST & SEAT
BOARD INTERFACE **(ONLY)**

ITEM NO.	DESCRIPTION	PART NUMBER
1	SECONDARY BACKREST RAIL INTERFACE (TO SUIT 19mm PUSH HANDLE TUBING) 19/25	L4-P53-19
2	SECONDARY BACKREST RAIL INTERFACE (TO SUIT 22mm PUSH HANDLE TUBING) 22/25	L4-P53-22
3	SECONDARY BACKREST RAIL INTERFACE (TO SUIT 25mm PUSH HANDLE TUBING) 25/25	L4-P53-25
4	CADDY UPPER BACKREST FRAME CLAMP (SHORT SLOT) ASSEMBLY	CDSP-04-05-STD
5	CADDY UPPER BACKREST FRAME CLAMP (LONG SLOT) ASSEMBLY	CDSP-04-05-POV
6	SECONDARY UPPER BACKREST FRAME CLAMP SPACERS (X2 3mm / X2 6mm) C/W FIXINGS	CDSP-04-05-3-6-S



Thompson House
Unit 10, Styles Close
Sittingbourne
Kent
ME10 3BF
01795 477280

www.ineedawheelchair.co.uk